



**Bowdoin**

Map Lot 09-10-0

Account 938

Location 213 WEST RD

Card 1 Of 1 7/19/2022

Building Style <b>8 Log Home</b>	SF Bsmt Living <b>0</b>	Layout <b>1 Typical</b>
0.Not Code 4.Cape 8.Log	Fin Bsmt Grade <b>0 0</b>	1.Typical 4. 7.
1.Conv. 5.Garrison 9.Other	OCCUPANCY <b>0</b>	2.Inadeq 5. 8.
2.Ranch 6.Split 10.DW	Heat Type <b>100% 1 Hot Water BB</b>	3.Poor 6. 9.
3.R Ranch 7.Contemp 11.Church	0.Not Code 4.Steam 8.F/Wall	Attic <b>9 None</b>
Dwelling Units <b>1</b>	1.HWBB 5.FWA 9.No Heat	1.1/4 Fin 4.Full Fin 7.
Other Units <b>0</b>	2.HWCI 6.GravWA 11.	2.1/2 Fin 5.F/Stair 8.
Stories <b>1 One Story</b>	3.H Pump 7.Electric 12.	3.3/4 Fin 6. 9.None
1.1 4.1.5 7.4	Cool Type <b>0% 9 None</b>	Insulation <b>1 Full</b>
2.2 5.1.75 8.20	1.Refrig 4.W&C Air 7.	1.Full 4.Minimal 7.
3.3 6.2.5 9.Yurt	2.Evapor 5. 8.	2.Heavy 5. 8.
Exterior Walls <b>1 Wood Siding</b>	3.H Pump 6. 9.None	3.Capped 6. 9.None
0.Not Code 4.Asbestos 8.Concrete	Kitchen Style <b>2 Typical</b>	Unfinished % <b>0%</b>
1.Wood 5.Stucco 9.Other	1.Modern 4.Obsolete 7.	Grade & Factor <b>3 Average 95%</b>
2.Vin/Al 6.Brick 10.Board B	2.Typical 5. 8.	1.E Grade 4.B Grade 7.
3.Compos. 7.Stone 12.	3.Old Type 6. 9.None	2.D Grade 5.A Grade 8.
Roof Surface <b>3 Sheet Metal</b>	Bath(s) Style <b>2 Typical Bath(s)</b>	3.C Grade 6.AA Grade 9.Same
1.Asphalt 4.Composit 7.	1.Modern 4.Obsolete 7.	SQFT (Footprint) <b>768</b>
2.Slate 5.Wood 8.	2.Typical 5. 8.	Condition <b>3 Below Average</b>
3.Metal 6.Other 9.	3.Old Type 6. 9.None	1.Poor 4.Avg 7.V G
SF Masonry Trim <b>0</b>	# Rooms <b>6</b>	2.Fair 5.Avg+ 8.Exc
SEPTIC DESIGN <b>0</b>	# Bedrooms <b>3</b>	3.Avg- 6.Good 9.Same
BLDG PERMIT <b>0</b>	# Full Baths <b>1</b>	Phys. % Good <b>0%</b>
Year Built <b>1971</b>	# Half Baths <b>0</b>	Funct. % Good <b>95%</b>
Year Remodeled <b>0</b>	# Addn Fixtures <b>0</b>	Functional Code <b>9 None</b>
Foundation <b>1 Concrete</b>	# Fireplaces <b>1</b>	1.Incomp 4.Delap 7.No Power
1.Concrete 4.Wood 7.		2.O-Built 5.Bsmt 8.LongTerm
2.C Block 5.Slab 8.		3.Damage 6.Dbwd 9.None
3.Br/Stone 6.Piers 9.		Econ. % Good <b>100%</b>
Basement <b>4 Full Basement</b>		Economic Code <b>None</b>
1.1/4 Bmt 4.Full Bmt 7.		0.None 3.No Power 7.
2.1/2 Bmt 5.None 8.		1.Location 4.Generate 8.
3.3/4 Bmt 6. 9.None		2.Encroach 9.None 9.
Bsmt Gar # Cars <b>0</b>		Entrance Code <b>5 Estimated</b>
Wet Basement <b>3 Wet Basement</b>		1.Interior 4.Vacant 7.Entered
1.Dry 4. 7.		2.Refusal 5.Estimate 8.No
2.Damp 5. 8.		3.Informed 6.Reviewed 9.Land
3.Wet 6. 9.		Information Code <b>6 Other</b>
		1.Owner 4.Agent 7.
		2.Relative 5.Estimate 8.
		3.Tenant 6.Other 9.

Date Inspected 3/26/2012

**Additions, Outbuildings & Improvements**

Type	Year	Units	Grade	Cond	Phys.	Funct.	Sound Value
21 Open Frame	1971	256	3 95	3	0 %	95 %	
22 Encl Frame Porch	1971	72	3 95	3	0 %	95 %	
30 Detached Garage	1971	480	3 95	3	0 %	95 %	
24 Frame Shed	0				%	%	300
					%	%	
					%	%	
					%	%	
					%	%	
					%	%	
					%	%	
					%	%	

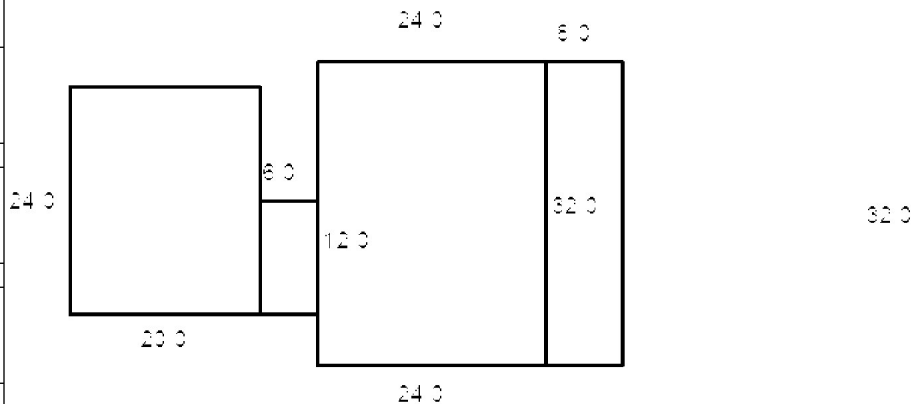

- 1.One Story Fram
- 2.Two Story Fram
- 3.Three Story Fr
- 4.1 & 1/2 Story
- 5.1 & 3/4 Story
- 6.2 & 1/2 Story
- 21.Open Frame Por
- 22.Encl Frame Por
- 23.Attached Garag
- 24.Frame Shed
- 25.Frame Bay Wind
- 26.1SFr Overhang
- 27.Unfin Basement
- 28.Unfinished Att
- 29.Finished Attic

HOLLAND, BURTRAM G  
HOLLAND, JUDITH  
229 WEST RD  
BOWDOIN ME 04287

B383P16

Inspection Witnessed By:

X		Date
No./Date	Description	Date Insp.

Notes:

**Bowdoin**

Property Data			Assessment Record				
Neighborhood <b>9 Map 9</b>			Year	Land	Buildings	Exempt	Total
Tree Growth Year <b>0</b>			2009	48,480	141,450	10,000	179,930
Farmland Yr <b>0</b>			2010	48,480	141,450	10,000	179,930
Open Space Yr <b>0</b>			2011	48,480	141,450	10,000	179,930
Zone/Land Use <b>11 Residential 1</b>			2012	48,480	141,450	10,000	179,930
Secondary Zone			2013	48,480	141,450	10,000	179,930
Topography			2014	48,480	134,740	10,000	173,220
1.Level 4.Below St 7.LevelBog			2015	48,480	134,740	10,000	173,220
2.Rolling 5.Low 8.Conform			2016	48,480	134,740	15,000	168,220
3.Above St 6.FZone 9.Non-Confor			2017	48,480	134,740	20,000	163,220
Utilities			2018	48,480	134,740	26,000	157,220
1.Public 4.Dr Well 7.Cesspool			2019	48,480	134,740	26,000	157,220
2.Water 5.Dug Well 8.			2020	48,480	134,740	31,000	152,220
3.Sewer 6.Septic 9.None			2021	48,480	134,740	31,000	152,220
Street <b>1 Paved</b>			2022	48,480	126,770	26,660	148,590
1.Paved 4.Proposed 7.MHG			<b>Land Data</b>				
2.Semi Imp 5.R/O/W 8.DIS							
3.Gravel 6.MHP 9.None			<b>Front Foot</b>				
TG PLAN YEAR <b>0</b>							
Tif District # <b>0</b>			<b>Type</b>				
<b>Sale Data</b>							
Sale Date			<b>Effective</b>				
Price							
Sale Type			<b>Influence</b>				
1.Land 4.Mobile 7.C/I L&B							
2.L & B 5.Other 8.			<b>Influence Codes</b>				
3.Building 6.C/I Land 9.							
Financing			<b>Square Foot</b>				
1.Convent 4.Seller 7.							
2.FHA/VA 5.Private 8.			<b>Square Feet</b>				
3.Assumed 6.Cash 9.Unknown							
Validity			<b>Fract. Acre</b>				
1.Valid 4.Split 7.Renovate							
2.Related 5.Partial 8.Other			<b>Acres</b>				
3.Distress 6.Exempt 9.Short							
Verified			<b>Acres</b>				
1.Buyer 4.Agent 7.Family							
2.Seller 5.Pub Rec 8.Other			<b>Total Acreage</b> 1.70				
3.Lender 6.MLS 9.							

- 1.Unimproved
- 2.Excess Frtg
- 3.Topography
- 4.Size/Shape
- 5.Access
- 6.Restriction
- 7.Open Space
- 8.View/Environ
- 9.Fract Share
- Acres**
- 30.Rear Land 3
- 31.Tillable
- 32.Pasture
- 33.Orchard
- 34.Softwood F&O
- 35.Mixed Wood F&O
- 36.Hardwood F&O
- 37.Softwood TG
- 38.Mixed Wood TG
- 39.Hardwood TG
- 40.Wasteland
- 41.Commercial
- 42.2nd Site
- 43.Post Rd
- 44.Lot Improvemen
- 45.Subdivision Lo
- 46.Golf Course

**Bowdoin**

Map Lot 09-11-0

Account 939

Location 229 WEST RD

Card 1 Of 1 7/19/2022

Building Style <b>2 Ranch</b>	SF Bsmt Living <b>0</b>	Layout <b>1 Typical</b>
0.Not Code 4.Cape 8.Log	Fin Bsmt Grade <b>0 100</b>	1.Typical 4. 7.
1.Conv. 5.Garrison 9.Other	OCCUPANCY <b>0</b>	2.Inadeq 5. 8.
2.Ranch 6.Split 10.DW	Heat Type <b>100% 1 Hot Water BB</b>	3.Poor 6. 9.
3.R Ranch 7.Contemp 11.Church	0.Not Code 4.Steam 8.FI/Wall	Attic <b>9 None</b>
Dwelling Units <b>1</b>	1.HWBB 5.FWA 9.No Heat	1.1/4 Fin 4.Full Fin 7.
Other Units <b>0</b>	2.HWCI 6.GravWA 11.	2.1/2 Fin 5.FI/Stair 8.
Stories <b>1 One Story</b>	3.H Pump 7.Electric 12.	3.3/4 Fin 6. 9.None
1.1 4.1.5 7.4	Cool Type <b>0% 9 None</b>	Insulation <b>0</b>
2.2 5.1.75 8.20	1.Refrig 4.W&C Air 7.	1.Full 4.Minimal 7.
3.3 6.2.5 9.Yurt	2.Evapor 5. 8.	2.Heavy 5. 8.
Exterior Walls <b>6 Brick</b>	3.H Pump 6. 9.None	3.Capped 6. 9.None
0.Not Code 4.Asbestos 8.Concrete	Kitchen Style <b>2 Typical</b>	Unfinished % <b>0%</b>
1.Wood 5.Stucco 9.Other	1.Modern 4.Obsolete 7.	Grade & Factor <b>4 Good 100%</b>
2.Vin/Al 6.Brick 10.Board B	2.Typical 5. 8.	1.E Grade 4.B Grade 7.
3.Compos. 7.Stone 12.	3.Old Type 6. 9.None	2.D Grade 5.A Grade 8.
Roof Surface <b>1 Asphalt Shingles</b>	Bath(s) Style <b>2 Typical Bath(s)</b>	3.C Grade 6.AA Grade 9.Same
1.Asphalt 4.Composit 7.	1.Modern 4.Obsolete 7.	SQFT (Footprint) <b>962</b>
2.Slate 5.Wood 8.	2.Typical 5. 8.	Condition <b>4 Average</b>
3.Metal 6.Other 9.	3.Old Type 6. 9.None	1.Poor 4.Avg 7.V G
SF Masonry Trim <b>0</b>	# Rooms <b>7</b>	2.Fair 5.Avg+ 8.Exc
SEPTIC DESIGN <b>0</b>	# Bedrooms <b>2</b>	3.Avg- 6.Good 9.Same
BLDG PERMIT <b>0</b>	# Full Baths <b>2</b>	Phys. % Good <b>0%</b>
Year Built <b>1971</b>	# Half Baths <b>0</b>	Funct. % Good <b>100%</b>
Year Remodeled <b>0</b>	# Addn Fixtures <b>0</b>	Functional Code <b>9 None</b>
Foundation <b>1 Concrete</b>	# Fireplaces <b>0</b>	1.Incomp 4.Delap 7.No Power
1.Concrete 4.Wood 7.	 <p><b>TRIO</b> Software A Division of Harris Computer Systems</p>	2.O-Built 5.Bsmt 8.LongTerm
2.C Block 5.Slab 8.		3.Damage 6.Dbwd 9.None
3.Br/Stone 6.Piers 9.		Econ. % Good <b>100%</b>
Basement <b>5 Crawl Space</b>		Economic Code <b>None</b>
1.1/4 Bmt 4.Full Bmt 7.		0.None 3.No Power 7.
2.1/2 Bmt 5.None 8.		1.Location 4.Generate 8.
3.3/4 Bmt 6. 9.None		2.Encroach 9.None 9.
Bsmt Gar # Cars <b>0</b>		Entrance Code <b>0</b>
Wet Basement <b>2 Damp Basement</b>		1.Interior 4.Vacant 7.Entered
1.Dry 4. 7.		2.Refusal 5.Estimate 8.No
2.Damp 5. 8.	3.Informed 6.Reviewed 9.Land	
3.Wet 6. 9.	Information Code <b>0</b>	
	1.Owner 4.Agent 7.	
	2.Relative 5.Estimate 8.	
	3.Tenant 6.Other 9.	

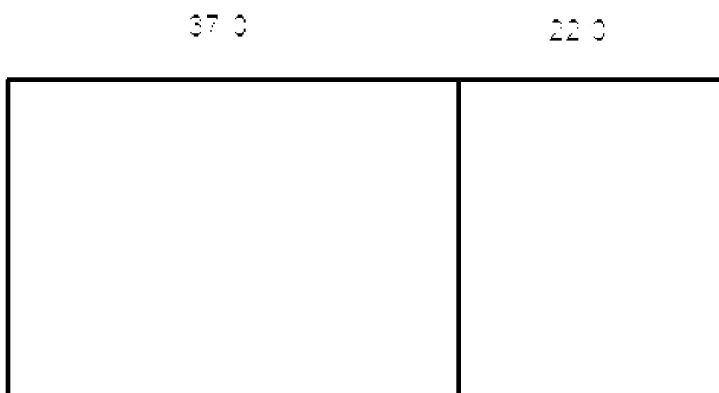

Date Inspected

**Additions, Outbuildings & Improvements**

Type	Year	Units	Grade	Cond	Phys.	Funct.	Sound Value
11 One	1982	572	3 110	3	0 %	100 %	
24 Frame Shed	2000	192	2 100	3	0 %	100 %	
24 Frame Shed	1971				%	%	300
24 Frame Shed	2000				%	%	300
					%	%	
					%	%	
					%	%	
					%	%	
					%	%	
					%	%	
					%	%	



- 1.One Story Fram
- 2.Two Story Fram
- 3.Three Story Fr
- 4.1 & 1/2 Story
- 5.1 & 3/4 Story
- 6.2 & 1/2 Story
- 21.Open Frame Por
- 22.Encl Frame Por
- 23.Attached Garag
- 24.Frame Shed
- 25.Frame Bay Wind
- 26.1SFr Overhang
- 27.Unfin Basement
- 28.Unfinished Att
- 29.Finished Attic

KNORR, BRIAN F  
KNORR, STACY R  
236 WEST RD  
BOWDOIN ME 04287

B2421P277

Previous Owner  
CARBONE, PETER J. & ERIKA  
236 WEST RD

BOWDOIN ME 04287  
Sale Date: 7/06/2004

Inspection Witnessed By:

X Date

No./Date	Description	Date Insp.

Notes:

**Bowdoin**

Property Data			Assessment Record				
Neighborhood <b>9 Map 9</b>			Year	Land	Buildings	Exempt	Total
Tree Growth Year <b>0</b>			2009	48,760	131,650	0	180,410
Farmland Yr <b>0</b>			2010	48,760	131,650	0	180,410
Open Space Yr <b>0</b>			2011	48,760	131,650	0	180,410
Zone/Land Use <b>11 Residential 1</b>			2012	48,760	131,650	0	180,410
Secondary Zone			2013	48,760	131,650	0	180,410
Topography			2014	48,760	131,650	0	180,410
1.Level 4.Below St 7.LevelBog			2015	48,760	140,620	0	189,380
2.Rolling 5.Low 8.Conform			2016	48,760	140,620	0	189,380
3.Above St 6.FZone 9.Non-Confor			2017	48,760	140,620	0	189,380
Utilities			2018	48,760	140,620	0	189,380
1.Public 4.Dr Well 7.Cesspool			2019	48,760	140,620	0	189,380
2.Water 5.Dug Well 8.			2020	48,760	140,620	0	189,380
3.Sewer 6.Septic 9.None			2021	48,760	140,620	0	189,380
Street <b>1 Paved</b>			2022	48,760	129,860	0	178,620
1.Paved 4.Proposed 7.MHG			<b>Land Data</b>				
2.Semi Imp 5.R/O/W 8.DIS							
3.Gravel 6.MHP 9.None			<b>Front Foot</b>				
TG PLAN YEAR <b>0</b>							
Tif District # <b>0</b>			<b>Type</b>				
<b>Sale Data</b>							
Sale Date <b>6/30/2004</b>			<b>Effective</b>				
Price <b>174,000</b>							
Sale Type <b>2 Land &amp; Buildings</b>			<b>Influence</b>				
1.Land 4.Mobile 7.C/I L&B							
2.L & B 5.Other 8.			<b>Influence Codes</b>				
3.Building 6.C/I Land 9.							
Financing			<b>Square Foot</b>				
1.Convent 4.Seller 7.							
2.FHA/VA 5.Private 8.			<b>Square Feet</b>				
3.Assumed 6.Cash 9.Unknown							
Validity <b>1 Arms Length Sale</b>			<b>Fract. Acre</b>				
1.Valid 4.Split 7.Renovate							
2.Related 5.Partial 8.Other			<b>Acres</b>				
3.Distress 6.Exempt 9.Short							
Verified			<b>Acres</b>				
1.Buyer 4.Agent 7.Family							
2.Seller 5.Pub Rec 8.Other			<b>Acres</b>				
3.Lender 6.MLS 9.							

- 1.Unimproved
- 2.Excess Frtg
- 3.Topography
- 4.Size/Shape
- 5.Access
- 6.Restriction
- 7.Open Space
- 8.View/Environ
- 9.Fract Share
- Acres**
- 30.Rear Land 3
- 31.Tillable
- 32.Pasture
- 33.Orchard
- 34.Softwood F&O
- 35.Mixed Wood F&O
- 36.Hardwood F&O
- 37.Softwood TG
- 38.Mixed Wood TG
- 39.Hardwood TG
- 40.Wasteland
- 41.Commercial
- 42.2nd Site
- 43.Post Rd
- 44.Lot Improvemen
- 45.Subdivision Lo
- 46.Golf Course

**Total Acreage 1.90**



**Bowdoin**

Map Lot 09-12-0

Account 940

Location 236 WEST RD

Card 1 Of 1 7/19/2022

Building Style <b>4 Cape Cod</b>	SF Bsmt Living <b>0</b>	Layout <b>1 Typical</b>
0.Not Code 4.Cape 8.Log	Fin Bsmt Grade <b>0 0</b>	1.Typical 4. 7.
1.Conv. 5.Garrison 9.Other	OCCUPANCY <b>0</b>	2.Inadeq 5. 8.
2.Ranch 6.Split 10.DW	Heat Type <b>100% 5 Forced Warm Air</b>	3.Poor 6. 9.
3.R Ranch 7.Contemp 11.Church	0.Not Code 4.Steam 8.FI/Wall	Attic <b>9 None</b>
Dwelling Units <b>1</b>	1.HWBB 5.FWA 9.No Heat	1.1/4 Fin 4.Full Fin 7.
Other Units <b>0</b>	2.HWCI 6.GravWA 11.	2.1/2 Fin 5.FI/Stair 8.
Stories <b>4 One &amp; 1/2 Story</b>	3.H Pump 7.Electric 12.	3.3/4 Fin 6. 9.None
1.1 4.1.5 7.4	Cool Type <b>0% 9 None</b>	Insulation <b>1 Full</b>
2.2 5.1.75 8.20	1.Refrig 4.W&C Air 7.	1.Full 4.Minimal 7.
3.3 6.2.5 9.Yurt	2.Evapor 5. 8.	2.Heavy 5. 8.
Exterior Walls <b>1 Wood Siding</b>	3.H Pump 6. 9.None	3.Capped 6. 9.None
0.Not Code 4.Asbestos 8.Concrete	Kitchen Style <b>2 Typical</b>	Unfinished % <b>0%</b>
1.Wood 5.Stucco 9.Other	1.Modern 4.Obsolete 7.	Grade & Factor <b>3 Average 100%</b>
2.Vin/Al 6.Brick 10.Board B	2.Typical 5. 8.	1.E Grade 4.B Grade 7.
3.Compos. 7.Stone 12.	3.Old Type 6. 9.None	2.D Grade 5.A Grade 8.
Roof Surface <b>1 Asphalt Shingles</b>	Bath(s) Style <b>2 Typical Bath(s)</b>	3.C Grade 6.AA Grade 9.Same
1.Asphalt 4.Composit 7.	1.Modern 4.Obsolete 7.	SQFT (Footprint) <b>1176</b>
2.Slate 5.Wood 8.	2.Typical 5. 8.	Condition <b>3 Below Average</b>
3.Metal 6.Other 9.	3.Old Type 6. 9.None	1.Poor 4.Avg 7.V G
SF Masonry Trim <b>0</b>	# Rooms <b>6</b>	2.Fair 5.Avg+ 8.Exc
SEPTIC DESIGN <b>0</b>	# Bedrooms <b>3</b>	3.Avg- 6.Good 9.Same
BLDG PERMIT <b>0</b>	# Full Baths <b>1</b>	Phys. % Good <b>0%</b>
Year Built <b>1989</b>	# Half Baths <b>0</b>	Funct. % Good <b>100%</b>
Year Remodeled <b>0</b>	# Addn Fixtures <b>0</b>	Functional Code <b>9 None</b>
Foundation <b>1 Concrete</b>	# Fireplaces <b>0</b>	1.Incomp 4.Delap 7.No Power
1.Concrete 4.Wood 7.	 <p><b>TRIO</b> Software A Division of Harris Computer Systems</p>	2.O-Built 5.Bsmt 8.LongTerm
2.C Block 5.Slab 8.		3.Damage 6.Dbwd 9.None
3.Br/Stone 6.Piers 9.		Econ. % Good <b>100%</b>
Basement <b>4 Full Basement</b>		Economic Code <b>None</b>
1.1/4 Bmt 4.Full Bmt 7.		0.None 3.No Power 7.
2.1/2 Bmt 5.None 8.		1.Location 4.Generate 8.
3.3/4 Bmt 6. 9.None		2.Encroach 9.None 9.
Bsmt Gar # Cars <b>0</b>		Entrance Code <b>0</b>
Wet Basement <b>3 Wet Basement</b>		1.Interior 4.Vacant 7.Entered
1.Dry 4. 7.		2.Refusal 5.Estimate 8.No
2.Damp 5. 8.	3.Informed 6.Reviewed 9.Land	
3.Wet 6. 9.	Information Code <b>0</b>	
	1.Owner 4.Agent 7.	
	2.Relative 5.Estimate 8.	
	3.Tenant 6.Other 9.	

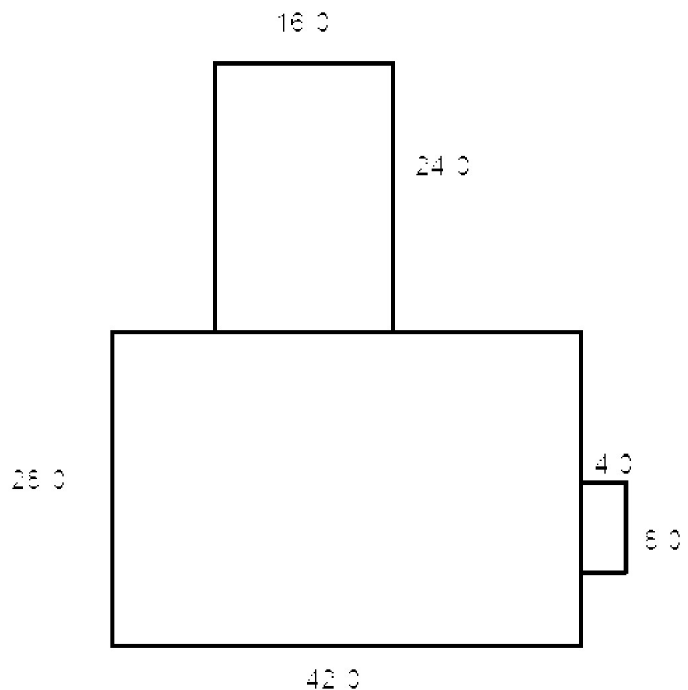

Date Inspected 4/13/2015

**Additions, Outbuildings & Improvements**

Type	Year	Units	Grade	Cond	Phys.	Funct.	Sound Value
21 Open Frame	1989	32	3 100	3	0 %	95 %	
68 Wood Deck	1989	384	3 100	3	0 %	95 %	
24 Frame Shed	0				%	%	200
63 Swimming Pool	2014	1	3 100	3	0 %	100 %	
68 Wood Deck	2014	144	3 100	3	0 %	100 %	
					%	%	
					%	%	
					%	%	
					%	%	
					%	%	
					%	%	



CREIGHTON, MARY  
224 WEST RD  
BOWDOIN ME 04287

B803P150

Inspection Witnessed By:

No./Date	Description	Date Insp.
X		

Notes:

**Bowdoin**

Property Data			Assessment Record						
Neighborhood <b>9 Map 9</b>			Year	Land	Buildings	Exempt	Total		
Tree Growth Year <b>0</b>			2009	57,700	221,950	10,000	269,650		
Farmland Yr <b>0</b>			2010	57,700	221,950	10,000	269,650		
Open Space Yr <b>0</b>			2011	57,700	221,950	10,000	269,650		
Zone/Land Use <b>11 Residential 1</b>			2012	66,700	221,950	10,000	278,650		
Secondary Zone			2013	66,700	221,950	10,000	278,650		
Topography			2014	66,700	221,950	10,000	278,650		
1.Level 4.Below St 7.LevelBog			2015	66,700	221,950	10,000	278,650		
2.Rolling 5.Low 8.Conform			2016	66,700	221,950	15,000	273,650		
3.Above St 6.FZone 9.Non-Confor			2017	66,700	221,950	20,000	268,650		
Utilities			2018	66,700	221,950	26,000	262,650		
1.Public 4.Dr Well 7.Cesspool			2019	66,700	221,950	26,000	262,650		
2.Water 5.Dug Well 8.			2020	66,700	221,950	31,000	257,650		
3.Sewer 6.Septic 9.None			2021	66,700	221,950	31,000	257,650		
Street <b>1 Paved</b>			2022	66,700	211,250	26,660	251,290		
1.Paved 4.Proposed 7.MHG			<b>Land Data</b>						
2.Semi Imp 5.R/O/W 8.DIS									
3.Gravel 6.MHP 9.None			<b>Front Foot</b>	<b>Type</b>	<b>Effective</b>		<b>Influence</b>		<b>Influence Codes</b>
TG PLAN YEAR <b>0</b>			11.Road Frontage		<b>Frontage</b>	<b>Depth</b>	<b>Factor</b>	<b>Code</b>	
Tif District # <b>0</b>			12.Delta Triangle				%		1.Unimproved
<b>Sale Data</b>			13.Nabla Triangle				%		2.Excess Frtg
Sale Date			14.Rear Land				%		3.Topography
Price			15.Miscellaneous				%		4.Size/Shape
Sale Type							%		5.Access
1.Land 4.Mobile 7.C/I L&B			<b>Square Foot</b>	<b>Square Feet</b>					6.Restriction
2.L & B 5.Other 8.			16.Regular Lot				%		7.Open Space
3.Building 6.C/I Land 9.			17.Secondary Lot				%		8.View/Environ
Financing			18.Hydro Facility				%		9.Fract Share
1.Convent 4.Seller 7.			19.Improvements				%		<b>Acres</b>
2.FHA/VA 5.Private 8.			20.Base 3 (Fract)				%		30.Rear Land 3
3.Assumed 6.Cash 9.Unknown							%		31.Tillable
Validity			<b>Fract. Acre</b>	<b>Acres/Sites</b>					32.Pasture
1.Valid 4.Split 7.Renovate			21.Base 1 (Fract)	25	1.00	100	%	0	33.Orchard
2.Related 5.Partial 8.Other			22.Base 2 (Fract)	28	16.00	100	%	0	34.Softwood F&O
3.Distress 6.Exempt 9.Short			23.Base 3	40	8.00	100	%	0	35.Mixed Wood F&O
Verified			<b>Acres</b>	44	1.00	100	%	0	36.Hardwood F&O
1.Buyer 4.Agent 7.Family			24.Base 1				%		37.Softwood TG
2.Seller 5.Pub Rec 8.Other			25.Base 2				%		38.Mixed Wood TG
3.Lender 6.MLS 9.			26.Frontage 1				%		39.Hardwood TG
			27.Rear Land 4				%		40.Wasteland
			28.Rear Land 1				%		41.Commercial
			29.Rear Land 2				%		42.2nd Site
			<b>Total Acreage</b>		<b>25.00</b>				43.Post Rd
									44.Lot Improvemen
									45.Subdivision Lo
									46.Golf Course

**Bowdoin**

Map Lot 09-12-01

Account 941

Location 224 WEST RD

Card 1

Of 1

7/19/2022

Building Style <b>1 Conventional</b>	SF Bsmt Living <b>0</b>	Layout <b>1 Typical</b>
0.Not Code 4.Cape 8.Log	Fin Bsmt Grade <b>0 0</b>	1.Typical 4. 7.
1.Conv. 5.Garrison 9.Other	OCCUPANCY <b>0</b>	2.Inadeq 5. 8.
2.Ranch 6.Split 10.DW	Heat Type <b>100% 1 Hot Water BB</b>	3.Poor 6. 9.
3.R Ranch 7.Contemp 11.Church	0.Not Code 4.Steam 8.FI/Wall	Attic <b>9 None</b>
Dwelling Units <b>1</b>	1.HWBB 5.FWA 9.No Heat	1.1/4 Fin 4.Full Fin 7.
Other Units <b>0</b>	2.HWCI 6.GravWA 11.	2.1/2 Fin 5.FI/Stair 8.
Stories <b>1 One Story</b>	3.H Pump 7.Electric 12.	3.3/4 Fin 6. 9.None
1.1 4.1.5 7.4	Cool Type <b>0% 9 None</b>	Insulation <b>1 Full</b>
2.2 5.1.75 8.20	1.Refrig 4.W&C Air 7.	1.Full 4.Minimal 7.
3.3 6.2.5 9.Yurt	2.Evapor 5. 8.	2.Heavy 5. 8.
Exterior Walls <b>1 Wood Siding</b>	3.H Pump 6. 9.None	3.Capped 6. 9.None
0.Not Code 4.Asbestos 8.Concrete	Kitchen Style <b>2 Typical</b>	Unfinished % <b>0%</b>
1.Wood 5.Stucco 9.Other	1.Modern 4.Obsolete 7.	Grade & Factor <b>4 Good 100%</b>
2.Vin/Al 6.Brick 10.Board B	2.Typical 5. 8.	1.E Grade 4.B Grade 7.
3.Compos. 7.Stone 12.	3.Old Type 6. 9.None	2.D Grade 5.A Grade 8.
Roof Surface <b>1 Asphalt Shingles</b>	Bath(s) Style <b>2 Typical Bath(s)</b>	3.C Grade 6.AA Grade 9.Same
1.Asphalt 4.Composit 7.	1.Modern 4.Obsolete 7.	SQFT (Footprint) <b>1909</b>
2.Slate 5.Wood 8.	2.Typical 5. 8.	Condition <b>4 Average</b>
3.Metal 6.Other 9.	3.Old Type 6. 9.None	1.Poor 4.Avg 7.V G
SF Masonry Trim <b>0</b>	# Rooms <b>8</b>	2.Fair 5.Avg+ 8.Exc
SEPTIC DESIGN <b>0</b>	# Bedrooms <b>3</b>	3.Avg- 6.Good 9.Same
BLDG PERMIT <b>0</b>	# Full Baths <b>2</b>	Phys. % Good <b>0%</b>
Year Built <b>1987</b>	# Half Baths <b>0</b>	Funct. % Good <b>100%</b>
Year Remodeled <b>0</b>	# Addn Fixtures <b>0</b>	Functional Code <b>9 None</b>
Foundation <b>1 Concrete</b>	# Fireplaces <b>1</b>	1.Incomp 4.Delap 7.No Power
1.Concrete 4.Wood 7.		2.O-Built 5.Bsmt 8.LongTerm
2.C Block 5.Slab 8.		Econ. % Good <b>100%</b>
3.Br/Stone 6.Piers 9.		Economic Code <b>None</b>
Basement <b>4 Full Basement</b>		0.None 3.No Power 7.
1.1/4 Bmt 4.Full Bmt 7.		1.Location 4.Generate 8.
2.1/2 Bmt 5.None 8.		2.Encroach 9.None 9.
3.3/4 Bmt 6. 9.None		Entrance Code <b>0</b>
Bsmt Gar # Cars <b>2</b>		1.Interior 4.Vacant 7.Entered
Wet Basement <b>1 Dry Basement</b>		2.Refusal 5.Estimate 8.No
1.Dry 4. 7.		3.Informed 6.Reviewed 9.Land
2.Damp 5. 8.	Information Code <b>0</b>	
3.Wet 6. 9.	1.Owner 4.Agent 7.	
	2.Relative 5.Estimate 8.	
	3.Tenant 6.Other 9.	

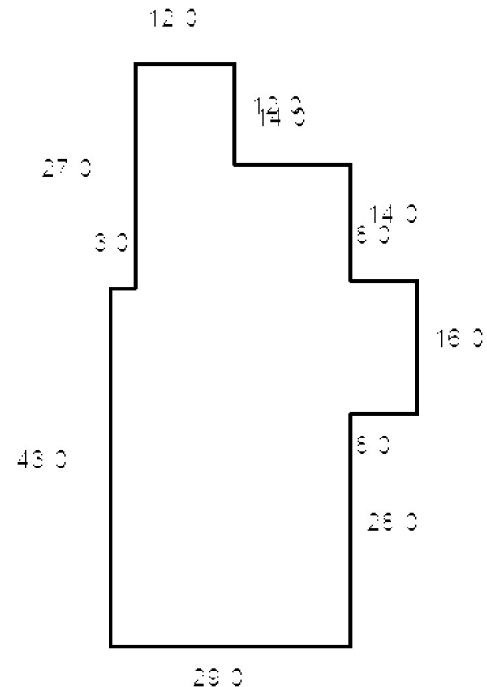

Date Inspected

**Additions, Outbuildings & Improvements**

Type	Year	Units	Grade	Cond	Phys.	Funct.	Sound Value
68 Wood Deck	1987	192	0 0	0	0 %	0 %	
68 Wood Deck	1987	376	0 0	0	0 %	0 %	
68 Wood Deck	1987	120	0 0	0	0 %	0 %	
24 Frame Shed	2000	64	2 100	4	0 %	100 %	
					%	%	
					%	%	
					%	%	
					%	%	
					%	%	
					%	%	
					%	%	



- 1.One Story Fram
- 2.Two Story Fram
- 3.Three Story Fr
- 4.1 & 1/2 Story
- 5.1 & 3/4 Story
- 6.2 & 1/2 Story
- 21.Open Frame Por
- 22.Encl Frame Por
- 23.Attached Garag
- 24.Frame Shed
- 25.Frame Bay Wind
- 26.1SFr Overhang
- 27.Unfin Basement
- 28.Unfinished Att
- 29.Finished Attic



MAINE, STATE OF  
DEPT OF INLAND FISHERIES & GAME  
AUGUSTA ME 04333

B868P302

Inspection Witnessed By:

No./Date	Description	Date Insp.
X		

Notes:

**Bowdoin**

Property Data			Assessment Record						
Neighborhood <b>9 Map 9</b>			Year	Land	Buildings	Exempt	Total		
Tree Growth Year <b>0</b>			2009	120,830	0	120,830	0		
Farmland Yr <b>0</b>			2010	120,830	0	120,830	0		
Open Space Yr <b>0</b>			2013	120,830	0	120,830	0		
Zone/Land Use <b>11 Residential 1</b>			2014	120,830	0	120,830	0		
Secondary Zone			2015	120,830	0	120,830	0		
Topography			2016	120,830	0	120,830	0		
1.Level 4.Below St 7.LevelBog			2017	120,830	0	120,830	0		
2.Rolling 5.Low 8.Conform			2018	120,830	0	120,830	0		
3.Above St 6.FZone 9.Non-Confor			2019	120,830	0	120,830	0		
Utilities			2020	120,830	0	120,830	0		
1.Public 4.Dr Well 7.Cesspool			2021	120,830	0	120,830	0		
2.Water 5.Dug Well 8.			2022	120,830	0	120,830	0		
3.Sewer 6.Septic 9.None									
Street <b>1 Paved</b>									
1.Paved 4.Proposed 7.MHG			<b>Land Data</b>						
2.Semi Imp 5.R/O/W 8.DIS									
3.Gravel 6.MHP 9.None									
TG PLAN YEAR <b>0</b>			<b>Front Foot</b>		<b>Effective</b>		<b>Influence</b>		<b>Influence Codes</b>
Tif District # <b>0</b>			Type		Frontage	Depth	Factor	Code	
<b>Sale Data</b>			11.Road Frontage				%		
Sale Date			12.Delta Triangle				%		
Price			13.Nabla Triangle				%		
Sale Type			14.Rear Land				%		
1.Land 4.Mobile 7.C/I L&B			15.Miscellaneous				%		
2.L & B 5.Other 8.			<b>Square Foot</b>		<b>Square Feet</b>				
3.Building 6.C/I Land 9.			16.Regular Lot				%		
Financing			17.Secondary Lot				%		
1.Convent 4.Seller 7.			18.Hydro Facility				%		
2.FHA/VA 5.Private 8.			19.Improvements				%		
3.Assumed 6.Cash 9.Unknown			20.Base 3 (Fract)				%		
Validity			<b>Fract. Acre</b>		<b>Acreage/Sites</b>				
1.Valid 4.Split 7.Renovate			21.Base 1 (Fract)		23	1.00	100 %	0	
2.Related 5.Partial 8.Other			22.Base 2 (Fract)		26	1.00	100 %	0	
3.Distress 6.Exempt 9.Short			23.Base 3		28	25.00	100 %	0	
Verified			<b>Acres</b>		29	25.00	100 %	0	
1.Buyer 4.Agent 7.Family			24.Base 1		30	50.00	100 %	0	
2.Seller 5.Pub Rec 8.Other			25.Base 2		27	27.00	100 %	0	
3.Lender 6.MLS 9.			26.Frontage 1		<b>Total Acreage 129.00</b>				
			27.Rear Land 4						
			28.Rear Land 1						
			29.Rear Land 2		46.Golf Course				

**Bowdoin**

Map Lot 09-13-0

Account 942

Location WEST RD

Card 1 Of 1 7/19/2022

Building Style <b>0 Not Coded</b>	SF Bsmt Living <b>0</b>	Layout <b>0</b>
0.Not Code 4.Cape 8.Log	Fin Bsmt Grade <b>0 0</b>	1.Typical 4. 7.
1.Conv. 5.Garrison 9.Other	OCCUPANCY <b>0</b>	2.Inadeq 5. 8.
2.Ranch 6.Split 10.DW	Heat Type <b>100% 0 Not Coded</b>	3.Poor 6. 9.
3.R Ranch 7.Contemp 11.Church	0.Not Code 4.Steam 8.FI/Wall	Attic <b>0</b>
Dwelling Units <b>0</b>	1.HWBB 5.FWA 9.No Heat	1.1/4 Fin 4.Full Fin 7.
Other Units <b>0</b>	2.HWCI 6.GravWA 11.	2.1/2 Fin 5.FI/Stair 8.
Stories <b>0</b>	3.H Pump 7.Electric 12.	3.3/4 Fin 6. 9.None
1.1 4.1.5 7.4	Cool Type <b>0% 9 None</b>	Insulation <b>0</b>
2.2 5.1.75 8.20	1.Refrig 4.W&C Air 7.	1.Full 4.Minimal 7.
3.3 6.2.5 9.Yurt	2.Evapor 5. 8.	2.Heavy 5. 8.
Exterior Walls <b>0 Not Coded</b>	3.H Pump 6. 9.None	3.Capped 6. 9.None
0.Not Code 4.Asbestos 8.Concrete	Kitchen Style <b>0</b>	Unfinished % <b>0%</b>
1.Wood 5.Stucco 9.Other	1.Modern 4.Obsolete 7.	Grade & Factor <b>0 0%</b>
2.Vin/Al 6.Brick 10.Board B	2.Typical 5. 8.	1.E Grade 4.B Grade 7.
3.Compos. 7.Stone 12.	3.Old Type 6. 9.None	2.D Grade 5.A Grade 8.
Roof Surface <b>0</b>	Bath(s) Style <b>0</b>	3.C Grade 6.AA Grade 9.Same
1.Asphalt 4.Composit 7.	1.Modern 4.Obsolete 7.	SQFT (Footprint) <b>0</b>
2.Slate 5.Wood 8.	2.Typical 5. 8.	Condition <b>0</b>
3.Metal 6.Other 9.	3.Old Type 6. 9.None	1.Poor 4.Avg 7.V G
SF Masonry Trim <b>0</b>	# Rooms <b>0</b>	2.Fair 5.Avg+ 8.Exc
SEPTIC DESIGN <b>0</b>	# Bedrooms <b>0</b>	3.Avg- 6.Good 9.Same
BLDG PERMIT <b>0</b>	# Full Baths <b>0</b>	Phys. % Good <b>0%</b>
Year Built <b>0</b>	# Half Baths <b>0</b>	Funct. % Good <b>100%</b>
Year Remodeled <b>0</b>	# Addn Fixtures <b>0</b>	Functional Code <b>9 None</b>
Foundation <b>0</b>	# Fireplaces <b>0</b>	1.Incomp 4.Delap 7.No Power
1.Concrete 4.Wood 7.		2.O-Built 5.Bsmt 8.LongTerm
2.C Block 5.Slab 8.		3.Damage 6.Dbwd 9.None
3.Br/Stone 6.Piers 9.		Econ. % Good <b>100%</b>
Basement <b>0</b>		Economic Code <b>None</b>
1.1/4 Bmt 4.Full Bmt 7.		0.None 3.No Power 7.
2.1/2 Bmt 5.None 8.		1.Location 4.Generate 8.
3.3/4 Bmt 6. 9.None		2.Encroach 9.None 9.
Bsmt Gar # Cars <b>0</b>		Entrance Code <b>0</b>
Wet Basement <b>0</b>		1.Interior 4.Vacant 7.Entered
1.Dry 4. 7.		2.Refusal 5.Estimate 8.No
2.Damp 5. 8.	3.Informed 6.Reviewed 9.Land	
3.Wet 6. 9.	Information Code <b>0</b>	
	1.Owner 4.Agent 7.	
	2.Relative 5.Estimate 8.	
	3.Tenant 6.Other 9.	

Date Inspected

**Additions, Outbuildings & Improvements**

Type	Year	Units	Grade	Cond	Phys.	Funct.	Sound Value
					%	%	1.One Story Fram
					%	%	2.Two Story Fram
					%	%	3.Three Story Fr
					%	%	4.1 & 1/2 Story
					%	%	5.1 & 3/4 Story
					%	%	6.2 & 1/2 Story
					%	%	21.Open Frame Por
					%	%	22.Encl Frame Por
					%	%	23.Attached Garag
					%	%	24.Frame Shed
					%	%	25.Frame Bay Wind
					%	%	26.1SFr Overhang
					%	%	27.Unfin Basement
					%	%	28.Unfinished Att
					%	%	29.Finished Attic

MAINE, STATE OF  
DEPT OF INLAND FISHERIES & GAME  
AUGUSTA ME 04333

B868P302

Inspection Witnessed By:

No./Date	Description	Date Insp.
X		

Notes:

**Bowdoin**

Property Data			Assessment Record						
Neighborhood <b>9 Map 9</b>			Year	Land	Buildings	Exempt	Total		
Tree Growth Year <b>0</b>			2009	91,900	0	91,900	0		
Farmland Yr <b>0</b>			2010	91,900	0	91,900	0		
Open Space Yr <b>0</b>			2013	91,900	0	91,900	0		
Zone/Land Use <b>11 Residential 1</b>			2014	91,900	0	91,900	0		
Secondary Zone			2015	91,900	0	91,900	0		
Topography			2016	91,900	0	91,900	0		
1.Level 4.Below St 7.LevelBog			2017	91,900	0	91,900	0		
2.Rolling 5.Low 8.Conform			2018	91,900	0	91,900	0		
3.Above St 6.FZone 9.Non-Confor			2019	91,900	0	91,900	0		
Utilities			2020	91,900	0	91,900	0		
1.Public 4.Dr Well 7.Cesspool			2021	91,900	0	91,900	0		
2.Water 5.Dug Well 8.			2022	91,900	0	91,900	0		
3.Sewer 6.Septic 9.None									
Street									
1.Paved 4.Proposed 7.MHG			<b>Land Data</b>						
2.Semi Imp 5.R/O/W 8.DIS									
3.Gravel 6.MHP 9.None									
TG PLAN YEAR <b>0</b>			<b>Front Foot</b>		<b>Effective</b>		<b>Influence</b>		<b>Influence Codes</b>
Tif District # <b>0</b>			Type		Frontage	Depth	Factor	Code	
<b>Sale Data</b>			11.Road Frontage				%		
Sale Date			12.Delta Triangle				%		
Price			13.Nabla Triangle				%		
Sale Type			14.Rear Land				%		
1.Land 4.Mobile 7.C/I L&B			15.Miscellaneous				%		
2.L & B 5.Other 8.							%		
3.Building 6.C/I Land 9.							%		
Financing			<b>Square Foot</b>		<b>Square Feet</b>				
1.Convent 4.Seller 7.			16.Regular Lot				%		
2.FHA/VA 5.Private 8.			17.Secondary Lot				%		
3.Assumed 6.Cash 9.Unknown			18.Hydro Facility				%		
Validity			19.Improvements				%		
1.Valid 4.Split 7.Renovate			20.Base 3 (Fract)				%		
2.Related 5.Partial 8.Other							%		
3.Distress 6.Exempt 9.Short							%		
Verified			<b>Fract. Acre</b>		<b>Acres/Sites</b>				
1.Buyer 4.Agent 7.Family			21.Base 1 (Fract)		30	131.00	100 %	0	
2.Seller 5.Pub Rec 8.Other			22.Base 2 (Fract)		40	2.00	100 %	0	
3.Lender 6.MLS 9.			23.Base 3				%		
			<b>Acres</b>				%		
			24.Base 1				%		
			25.Base 2				%		
			26.Frontage 1				%		
			27.Rear Land 4				%		
			28.Rear Land 1				%		
			29.Rear Land 2				%		
			<b>Total Acreage</b>		133.00				

- 1.Unimproved
- 2.Excess Frtg
- 3.Topography
- 4.Size/Shape
- 5.Access
- 6.Restriction
- 7.Open Space
- 8.View/Environ
- 9.Fract Share
- Acres**
- 30.Rear Land 3
- 31.Tillable
- 32.Pasture
- 33.Orchard
- 34.Softwood F&O
- 35.Mixed Wood F&O
- 36.Hardwood F&O
- 37.Softwood TG
- 38.Mixed Wood TG
- 39.Hardwood TG
- 40.Wasteland
- 41.Commercial
- 42.2nd Site
- 43.Post Rd
- 44.Lot Improvemen
- 45.Subdivision Lo
- 46.Golf Course

**Bowdoin**

Map Lot 09-14-0

Account 943

Location WAGG RD

Card 1 Of 1 7/19/2022

Building Style <b>0 Not Coded</b>	SF Bsmt Living <b>0</b>	Layout <b>0</b>
0.Not Code 4.Cape 8.Log	Fin Bsmt Grade <b>0 0</b>	1.Typical 4. 7.
1.Conv. 5.Garrison 9.Other	OCCUPANCY <b>0</b>	2.Inadeq 5. 8.
2.Ranch 6.Split 10.DW	Heat Type <b>100% 0 Not Coded</b>	3.Poor 6. 9.
3.R Ranch 7.Contemp 11.Church	0.Not Code 4.Steam 8.FI/Wall	Attic <b>0</b>
Dwelling Units <b>0</b>	1.HWBB 5.FWA 9.No Heat	1.1/4 Fin 4.Full Fin 7.
Other Units <b>0</b>	2.HWCI 6.GravWA 11.	2.1/2 Fin 5.FI/Stair 8.
Stories <b>0</b>	3.H Pump 7.Electric 12.	3.3/4 Fin 6. 9.None
1.1 4.1.5 7.4	Cool Type <b>0% 9 None</b>	Insulation <b>0</b>
2.2 5.1.75 8.20	1.Refrig 4.W&C Air 7.	1.Full 4.Minimal 7.
3.3 6.2.5 9.Yurt	2.Evapor 5. 8.	2.Heavy 5. 8.
Exterior Walls <b>0 Not Coded</b>	3.H Pump 6. 9.None	3.Capped 6. 9.None
0.Not Code 4.Asbestos 8.Concrete	Kitchen Style <b>0</b>	Unfinished % <b>0%</b>
1.Wood 5.Stucco 9.Other	1.Modern 4.Obsolete 7.	Grade & Factor <b>0 0%</b>
2.Vin/Al 6.Brick 10.Board B	2.Typical 5. 8.	1.E Grade 4.B Grade 7.
3.Compos. 7.Stone 12.	3.Old Type 6. 9.None	2.D Grade 5.A Grade 8.
Roof Surface <b>0</b>	Bath(s) Style <b>0</b>	3.C Grade 6.AA Grade 9.Same
1.Asphalt 4.Composit 7.	1.Modern 4.Obsolete 7.	SQFT (Footprint) <b>0</b>
2.Slate 5.Wood 8.	2.Typical 5. 8.	Condition <b>0</b>
3.Metal 6.Other 9.	3.Old Type 6. 9.None	1.Poor 4.Avg 7.V G
SF Masonry Trim <b>0</b>	# Rooms <b>0</b>	2.Fair 5.Avg+ 8.Exc
SEPTIC DESIGN <b>0</b>	# Bedrooms <b>0</b>	3.Avg- 6.Good 9.Same
BLDG PERMIT <b>0</b>	# Full Baths <b>0</b>	Phys. % Good <b>0%</b>
Year Built <b>0</b>	# Half Baths <b>0</b>	Funct. % Good <b>100%</b>
Year Remodeled <b>0</b>	# Addn Fixtures <b>0</b>	Functional Code <b>9 None</b>
Foundation <b>0</b>	# Fireplaces <b>0</b>	1.Incomp 4.Delap 7.No Power
1.Concrete 4.Wood 7.		2.O-Built 5.Bsmt 8.LongTerm
2.C Block 5.Slab 8.		3.Damage 6.Dbwd 9.None
3.Br/Stone 6.Piers 9.		Econ. % Good <b>100%</b>
Basement <b>0</b>		Economic Code <b>None</b>
1.1/4 Bmt 4.Full Bmt 7.		0.None 3.No Power 7.
2.1/2 Bmt 5.None 8.		1.Location 4.Generate 8.
3.3/4 Bmt 6. 9.None		2.Encroach 9.None 9.
Bsmt Gar # Cars <b>0</b>		Entrance Code <b>0</b>
Wet Basement <b>0</b>		1.Interior 4.Vacant 7.Entered
1.Dry 4. 7.		2.Refusal 5.Estimate 8.No
2.Damp 5. 8.	3.Informed 6.Reviewed 9.Land	
3.Wet 6. 9.	Information Code <b>0</b>	
	1.Owner 4.Agent 7.	
	2.Relative 5.Estimate 8.	
	3.Tenant 6.Other 9.	

Date Inspected

**Additions, Outbuildings & Improvements**

Type	Year	Units	Grade	Cond	Phys.	Funct.	Sound Value
					%	%	1.One Story Fram
					%	%	2.Two Story Fram
					%	%	3.Three Story Fr
					%	%	4.1 & 1/2 Story
					%	%	5.1 & 3/4 Story
					%	%	6.2 & 1/2 Story
					%	%	21.Open Frame Por
					%	%	22.Encl Frame Por
					%	%	23.Attached Garag
					%	%	24.Frame Shed
					%	%	25.Frame Bay Wind
					%	%	26.1SFr Overhang
					%	%	27.Unfin Basement
					%	%	28.Unfinished Att
					%	%	29.Finished Attic





**Bowdoin**

Map Lot 09-15-0

Account 944

Location WAGG RD

Card 1 Of 1 7/19/2022

Building Style <b>0 Not Coded</b>	SF Bsmt Living <b>0</b>	Layout <b>0</b>
0.Not Code 4.Cape 8.Log	Fin Bsmt Grade <b>0 0</b>	1.Typical 4. 7.
1.Conv. 5.Garrison 9.Other	OCCUPANCY <b>0</b>	2.Inadeq 5. 8.
2.Ranch 6.Split 10.DW	Heat Type <b>100% 0 Not Coded</b>	3.Poor 6. 9.
3.R Ranch 7.Contemp 11.Church	0.Not Code 4.Steam 8.FI/Wall	Attic <b>0</b>
Dwelling Units <b>0</b>	1.HWBB 5.FWA 9.No Heat	1.1/4 Fin 4.Full Fin 7.
Other Units <b>0</b>	2.HWCI 6.GravWA 11.	2.1/2 Fin 5.FI/Stair 8.
Stories <b>0</b>	3.H Pump 7.Electric 12.	3.3/4 Fin 6. 9.None
1.1 4.1.5 7.4	Cool Type <b>0% 9 None</b>	Insulation <b>0</b>
2.2 5.1.75 8.20	1.Refrig 4.W&C Air 7.	1.Full 4.Minimal 7.
3.3 6.2.5 9.Yurt	2.Evapor 5. 8.	2.Heavy 5. 8.
Exterior Walls <b>0 Not Coded</b>	3.H Pump 6. 9.None	3.Capped 6. 9.None
0.Not Code 4.Asbestos 8.Concrete	Kitchen Style <b>0</b>	Unfinished % <b>0%</b>
1.Wood 5.Stucco 9.Other	1.Modern 4.Obsolete 7.	Grade & Factor <b>0 0%</b>
2.Vin/Al 6.Brick 10.Board B	2.Typical 5. 8.	1.E Grade 4.B Grade 7.
3.Compos. 7.Stone 12.	3.Old Type 6. 9.None	2.D Grade 5.A Grade 8.
Roof Surface <b>0</b>	Bath(s) Style <b>0</b>	3.C Grade 6.AA Grade 9.Same
1.Asphalt 4.Composit 7.	1.Modern 4.Obsolete 7.	SQFT (Footprint) <b>0</b>
2.Slate 5.Wood 8.	2.Typical 5. 8.	Condition <b>0</b>
3.Metal 6.Other 9.	3.Old Type 6. 9.None	1.Poor 4.Avg 7.V G
SF Masonry Trim <b>0</b>	# Rooms <b>0</b>	2.Fair 5.Avg+ 8.Exc
SEPTIC DESIGN <b>0</b>	# Bedrooms <b>0</b>	3.Avg- 6.Good 9.Same
BLDG PERMIT <b>0</b>	# Full Baths <b>0</b>	Phys. % Good <b>0%</b>
Year Built <b>0</b>	# Half Baths <b>0</b>	Funct. % Good <b>100%</b>
Year Remodeled <b>0</b>	# Addn Fixtures <b>0</b>	Functional Code <b>9 None</b>
Foundation <b>0</b>	# Fireplaces <b>0</b>	1.Incomp 4.Delap 7.No Power
1.Concrete 4.Wood 7.		2.O-Built 5.Bsmt 8.LongTerm
2.C Block 5.Slab 8.		3.Damage 6.Dbwd 9.None
3.Br/Stone 6.Piers 9.		Econ. % Good <b>100%</b>
Basement <b>0</b>		Economic Code <b>None</b>
1.1/4 Bmt 4.Full Bmt 7.		0.None 3.No Power 7.
2.1/2 Bmt 5.None 8.		1.Location 4.Generate 8.
3.3/4 Bmt 6. 9.None		2.Encroach 9.None 9.
Bsmt Gar # Cars <b>0</b>		Entrance Code <b>0</b>
Wet Basement <b>0</b>		1.Interior 4.Vacant 7.Entered
1.Dry 4. 7.		2.Refusal 5.Estimate 8.No
2.Damp 5. 8.		3.Informed 6.Reviewed 9.Land
3.Wet 6. 9.		Information Code <b>0</b>
		1.Owner 4.Agent 7.
		2.Relative 5.Estimate 8.
		3.Tenant 6.Other 9.



Date Inspected

Additions, Outbuildings & Improvements								
Type	Year	Units	Grade	Cond	Phys.	Funct.	Sound Value	
					%	%		1.One Story Fram
					%	%		2.Two Story Fram
					%	%		3.Three Story Fr
					%	%		4.1 & 1/2 Story
					%	%		5.1 & 3/4 Story
					%	%		6.2 & 1/2 Story
					%	%		21.Open Frame Por
					%	%		22.Encl Frame Por
					%	%		23.Attached Garag
					%	%		24.Frame Shed
					%	%		25.Frame Bay Wind
					%	%		26.1SFr Overhang
					%	%		27.Unfin Basement
					%	%		28.Unfinished Att
					%	%		29.Finished Attic

DWYER, NORRIS J  
 DWYER, CHERYL L  
 490 WEST RD  
 BOWDOIN ME 04287

B428P6

Property Data			Assessment Record				
Neighborhood <b>9 Map 9</b>			Year	Land	Buildings	Exempt	Total
Tree Growth Year <b>0</b>			2009	50,340	0	0	50,340
Farmland Yr <b>0</b>			2010	50,340	0	0	50,340
Open Space Yr <b>0</b>			2011	50,340	0	0	50,340
Zone/Land Use <b>11 Residential 1</b>			2012	52,840	0	0	52,840
Secondary Zone			2013	52,840	0	0	52,840
Topography			2014	52,840	0	0	52,840
1.Level 4.Below St 7.LevelBog			2015	52,840	0	0	52,840
2.Rolling 5.Low 8.Conform			2016	52,840	0	0	52,840
3.Above St 6.FZone 9.Non-Confor			2017	52,840	0	0	52,840
Utilities			2018	52,840	0	0	52,840
1.Public 4.Dr Well 7.Cesspool			2019	52,840	0	0	52,840
2.Water 5.Dug Well 8.			2020	52,840	0	0	52,840
3.Sewer 6.Septic 9.None			2021	52,840	0	0	52,840
Street			2022	52,840	0	0	52,840
1.Paved 4.Proposed 7.MHG							
2.Semi Imp 5.R/O/W 8.DIS							
3.Gravel 6.MHP 9.None							

Inspection Witnessed By:

X	Date	Date Insp.
No./Date	Description	Date Insp.

Notes:

Land Data						
Front Foot	Type	Effective		Influence		Influence Codes
		Frontage	Depth	Factor	Code	
11.Road Frontage				%		1.Unimproved
12.Delta Triangle				%		2.Excess Frtg
13.Nabla Triangle				%		3.Topography
14.Rear Land				%		4.Size/Shape
15.Miscellaneous				%		5.Access
				%		6.Restriction
				%		7.Open Space
				%		8.View/Environ
				%		9.Fract Share
Square Foot		Square Feet				Acres
16.Regular Lot				%		30.Rear Land 3
17.Secondary Lot				%		31.Tillable
18.Hydro Facility				%		32.Pasture
19.Improvements				%		33.Orchard
20.Base 3 (Fract)				%		34.Softwood F&O
Fract. Acre		Acreage/Sites				
21.Base 1 (Fract)	23	1.00	100	%	0	35.Mixed Wood F&O
22.Base 2 (Fract)	28	25.00	100	%	0	36.Hardwood F&O
23.Base 3	29	7.60	100	%	0	37.Softwood TG
Acres		40	2.40	100	0	38.Mixed Wood TG
24.Base 1				%		39.Hardwood TG
25.Base 2				%		40.Wasteland
26.Frontage 1				%		41.Commercial
27.Rear Land 4				%		42.2nd Site
28.Rear Land 1				%		43.Post Rd
29.Rear Land 2				%		44.Lot Improvemen
<b>Total Acreage</b>				36.00		45.Subdivision Lo
						46.Golf Course

**Bowdoin**

**Bowdoin**

Map Lot 09-16-0

Account 945

Location WAGG RD

Card 1 Of 1 7/19/2022

Building Style <b>0 Not Coded</b>	SF Bsmt Living <b>0</b>	Layout <b>0</b>
0.Not Code 4.Cape 8.Log	Fin Bsmt Grade <b>0 0</b>	1.Typical 4. 7.
1.Conv. 5.Garrison 9.Other	OCCUPANCY <b>0</b>	2.Inadeq 5. 8.
2.Ranch 6.Split 10.DW	Heat Type <b>100% 0 Not Coded</b>	3.Poor 6. 9.
3.R Ranch 7.Contemp 11.Church	0.Not Code 4.Steam 8.FI/Wall	Attic <b>0</b>
Dwelling Units <b>0</b>	1.HWBB 5.FWA 9.No Heat	1.1/4 Fin 4.Full Fin 7.
Other Units <b>0</b>	2.HWCI 6.GravWA 11.	2.1/2 Fin 5.FI/Stair 8.
Stories <b>0</b>	3.H Pump 7.Electric 12.	3.3/4 Fin 6. 9.None
1.1 4.1.5 7.4	Cool Type <b>0% 9 None</b>	Insulation <b>0</b>
2.2 5.1.75 8.20	1.Refrig 4.W&C Air 7.	1.Full 4.Minimal 7.
3.3 6.2.5 9.Yurt	2.Evapor 5. 8.	2.Heavy 5. 8.
Exterior Walls <b>0 Not Coded</b>	3.H Pump 6. 9.None	3.Capped 6. 9.None
0.Not Code 4.Asbestos 8.Concrete	Kitchen Style <b>0</b>	Unfinished % <b>0%</b>
1.Wood 5.Stucco 9.Other	1.Modern 4.Obsolete 7.	Grade & Factor <b>0 0%</b>
2.Vin/Al 6.Brick 10.Board B	2.Typical 5. 8.	1.E Grade 4.B Grade 7.
3.Compos. 7.Stone 12.	3.Old Type 6. 9.None	2.D Grade 5.A Grade 8.
Roof Surface <b>0</b>	Bath(s) Style <b>0</b>	3.C Grade 6.AA Grade 9.Same
1.Asphalt 4.Composit 7.	1.Modern 4.Obsolete 7.	SQFT (Footprint) <b>0</b>
2.Slate 5.Wood 8.	2.Typical 5. 8.	Condition <b>0</b>
3.Metal 6.Other 9.	3.Old Type 6. 9.None	1.Poor 4.Avg 7.V G
SF Masonry Trim <b>0</b>	# Rooms <b>0</b>	2.Fair 5.Avg+ 8.Exc
SEPTIC DESIGN <b>0</b>	# Bedrooms <b>0</b>	3.Avg- 6.Good 9.Same
BLDG PERMIT <b>0</b>	# Full Baths <b>0</b>	Phys. % Good <b>0%</b>
Year Built <b>0</b>	# Half Baths <b>0</b>	Funct. % Good <b>100%</b>
Year Remodeled <b>0</b>	# Addn Fixtures <b>0</b>	Functional Code <b>9 None</b>
Foundation <b>0</b>	# Fireplaces <b>0</b>	1.Incomp 4.Delap 7.No Power
1.Concrete 4.Wood 7.		2.O-Built 5.Bsmt 8.LongTerm
2.C Block 5.Slab 8.		3.Damage 6.Dbwd 9.None
3.Br/Stone 6.Piers 9.		Econ. % Good <b>100%</b>
Basement <b>0</b>		Economic Code <b>None</b>
1.1/4 Bmt 4.Full Bmt 7.		0.None 3.No Power 7.
2.1/2 Bmt 5.None 8.		1.Location 4.Generate 8.
3.3/4 Bmt 6. 9.None		2.Encroach 9.None 9.
Bsmt Gar # Cars <b>0</b>		Entrance Code <b>0</b>
Wet Basement <b>0</b>		1.Interior 4.Vacant 7.Entered
1.Dry 4. 7.		2.Refusal 5.Estimate 8.No
2.Damp 5. 8.	3.Informed 6.Reviewed 9.Land	
3.Wet 6. 9.	Information Code <b>0</b>	
	1.Owner 4.Agent 7.	
	2.Relative 5.Estimate 8.	
	3.Tenant 6.Other 9.	

Date Inspected

**Additions, Outbuildings & Improvements**

Type	Year	Units	Grade	Cond	Phys.	Funct.	Sound Value
					%	%	1.One Story Fram
					%	%	2.Two Story Fram
					%	%	3.Three Story Fr
					%	%	4.1 & 1/2 Story
					%	%	5.1 & 3/4 Story
					%	%	6.2 & 1/2 Story
					%	%	21.Open Frame Por
					%	%	22.Encl Frame Por
					%	%	23.Attached Garag
					%	%	24.Frame Shed
					%	%	25.Frame Bay Wind
					%	%	26.1SFr Overhang
					%	%	27.Unfin Basement
					%	%	28.Unfinished Att
					%	%	29.Finished Attic



SANBORN, LOREN  
262 WEST RD  
BOWDOIN ME 04287

B367P606 B2018RP7076 B2019RP2576

Previous Owner  
GOULD, DEVISEES OF LELAND  
P/R THOMAS L. GOULD  
5 GROVE STREET  
LEWISTON ME 04252  
Sale Date: 5/03/2019

Inspection Witnessed By:

X	Date
No./Date	Description

Notes:

**Bowdoin**

Property Data			Assessment Record						
Neighborhood <b>9 Map 9</b>			Year	Land	Buildings	Exempt	Total		
Tree Growth Year <b>0</b>			2009	54,700	37,800	10,000	82,500		
Farmland Yr <b>0</b>			2010	54,700	40,360	10,000	85,060		
Open Space Yr <b>0</b>			2011	54,700	40,360	10,000	85,060		
Zone/Land Use <b>11 Residential 1</b>			2012	54,700	40,360	10,000	85,060		
Secondary Zone			2013	54,700	40,360	10,000	85,060		
Topography			2014	54,700	40,360	10,000	85,060		
1.Level 4.Below St 7.LevelBog			2015	54,700	40,360	10,000	85,060		
2.Rolling 5.Low 8.Conform			2016	54,700	40,360	15,000	80,060		
3.Above St 6.FZone 9.Non-Confor			2017	52,660	40,360	20,000	73,020		
Utilities			2018	52,660	40,360	20,000	73,020		
1.Public 4.Dr Well 7.Cesspool			2019	52,660	40,360	0	93,020		
2.Water 5.Dug Well 8.			2020	52,660	40,360	0	93,020		
3.Sewer 6.Septic 9.None			2021	52,660	40,360	0	93,020		
Street <b>1 Paved</b>			2022	52,660	33,980	0	86,640		
1.Paved 4.Proposed 7.MHG			<b>Land Data</b>						
2.Semi Imp 5.R/O/W 8.DIS									
3.Gravel 6.MHP 9.None			<b>Front Foot</b>	<b>Type</b>	<b>Effective</b>		<b>Influence</b>		<b>Influence Codes</b>
TG PLAN YEAR <b>0</b>			11.Road Frontage		<b>Frontage</b>	<b>Depth</b>	<b>Factor</b>	<b>Code</b>	
Tif District # <b>0</b>			12.Delta Triangle				%		1.Unimproved
<b>Sale Data</b>			13.Nabla Triangle				%		2.Excess Frtg
Sale Date <b>5/03/2019</b>			14.Rear Land				%		3.Topography
Price <b>89,500</b>			15.Miscellaneous				%		4.Size/Shape
Sale Type <b>2 Land &amp; Buildings</b>							%		5.Access
1.Land 4.Mobile 7.C/I L&B			<b>Square Foot</b>	<b>Square Feet</b>					6.Restriction
2.L & B 5.Other 8.			16.Regular Lot				%		7.Open Space
3.Building 6.C/I Land 9.			17.Secondary Lot				%		8.View/Environ
Financing <b>9 Unknown</b>			18.Hydro Facility				%		9.Fract Share
1.Convent 4.Seller 7.			19.Improvements				%		<b>Acres</b>
2.FHA/VA 5.Private 8.			20.Base 3 (Fract)				%		30.Rear Land 3
3.Assumed 6.Cash 9.Unknown							%		31.Tillable
Validity <b>8 Other Non Valid</b>			<b>Fract. Acre</b>	<b>Acres/Sites</b>					32.Pasture
1.Valid 4.Split 7.Renovate			21.Base 1 (Fract)	24	1.00	100	%	0	33.Orchard
2.Related 5.Partial 8.Other			22.Base 2 (Fract)	28	1.54	100	%	0	34.Softwood F&O
3.Distress 6.Exempt 9.Short			23.Base 3	44	1.00	100	%	0	35.Mixed Wood F&O
Verified <b>5 Public Record</b>			<b>Acres</b>	26	1.00	100	%	0	36.Hardwood F&O
1.Buyer 4.Agent 7.Family			24.Base 1				%		37.Softwood TG
2.Seller 5.Pub Rec 8.Other			25.Base 2				%		38.Mixed Wood TG
3.Lender 6.MLS 9.			26.Frontage 1				%		39.Hardwood TG
			27.Rear Land 4				%		40.Wasteland
			28.Rear Land 1				%		41.Commercial
			29.Rear Land 2				%		42.2nd Site
			<b>Total Acreage</b>		3.54				43.Post Rd
									44.Lot Improvemen
									45.Subdivision Lo
									46.Golf Course



BOWDOIN, TOWN OF  
P.O. BOX 35  
BOWDOIN ME 04287

			Property Data			Assessment Record																																																																																																																																																																																																																	
			Neighborhood	9 Map 9		Year	Land	Buildings	Exempt	Total																																																																																																																																																																																																													
			Tree Growth Year 0			2009	21,440	0	21,440	0																																																																																																																																																																																																													
			Farmland Yr 0			2010	21,440	0	21,440	0																																																																																																																																																																																																													
			Open Space Yr 0			2013	55,750	0	55,750	0																																																																																																																																																																																																													
			Zone/Land Use 11 Residential 1			2014	55,750	0	55,750	0																																																																																																																																																																																																													
			Secondary Zone			2015	55,750	0	55,750	0																																																																																																																																																																																																													
			Topography			2016	55,750	0	55,750	0																																																																																																																																																																																																													
			1.Level 4.Below St 7.LevelBog			2017	55,750	0	55,750	0																																																																																																																																																																																																													
			2.Rolling 5.Low 8.Conform			2018	55,750	0	55,750	0																																																																																																																																																																																																													
			3.Above St 6.FZone 9.Non-Confor			2019	55,750	0	55,750	0																																																																																																																																																																																																													
			Utilities			2020	55,750	0	55,750	0																																																																																																																																																																																																													
			1.Public 4.Dr Well 7.Cesspool			2021	55,750	0	55,750	0																																																																																																																																																																																																													
			2.Water 5.Dug Well 8.			2022	55,750	0	55,750	0																																																																																																																																																																																																													
			3.Sewer 6.Septic 9.None																																																																																																																																																																																																																				
			Street 1 Paved																																																																																																																																																																																																																				
			1.Paved 4.Proposed 7.MHG			<table border="1"> <thead> <tr> <th colspan="5">Land Data</th> </tr> <tr> <th rowspan="2">Front Foot</th> <th rowspan="2">Type</th> <th colspan="2">Effective</th> <th colspan="2">Influence</th> <th rowspan="2">Influence Codes</th> </tr> <tr> <th>Frontage</th> <th>Depth</th> <th>Factor</th> <th>Code</th> </tr> </thead> <tbody> <tr> <td>11.Road Frontage</td> <td></td> <td></td> <td></td> <td>%</td> <td></td> <td>1.Unimproved</td> </tr> <tr> <td>12.Delta Triangle</td> <td></td> <td></td> <td></td> <td>%</td> <td></td> <td>2.Excess Frtg</td> </tr> <tr> <td>13.Nabla Triangle</td> <td></td> <td></td> <td></td> <td>%</td> <td></td> <td>3.Topography</td> </tr> <tr> <td>14.Rear Land</td> <td></td> <td></td> <td></td> <td>%</td> <td></td> <td>4.Size/Shape</td> </tr> <tr> <td>15.Miscellaneous</td> <td></td> <td></td> <td></td> <td>%</td> <td></td> <td>5.Access</td> </tr> <tr> <td></td> <td></td> <td></td> <td></td> <td>%</td> <td></td> <td>6.Restriction</td> </tr> <tr> <td></td> <td></td> <td></td> <td></td> <td>%</td> <td></td> <td>7.Open Space</td> </tr> <tr> <td></td> <td></td> <td></td> <td></td> <td>%</td> <td></td> <td>8.View/Environ</td> </tr> <tr> <td></td> <td></td> <td></td> <td></td> <td>%</td> <td></td> <td>9.Fract Share</td> </tr> <tr> <td></td> <td></td> <td></td> <td></td> <td>%</td> <td></td> <td>Acres</td> </tr> <tr> <td></td> <td></td> <td></td> <td></td> <td>%</td> <td></td> <td>30.Rear Land 3</td> </tr> <tr> <td></td> <td></td> <td></td> <td></td> <td>%</td> <td></td> <td>31.Tillable</td> </tr> <tr> <td></td> <td></td> <td></td> <td></td> <td>%</td> <td></td> <td>32.Pasture</td> </tr> <tr> <td></td> <td></td> <td></td> <td></td> <td>%</td> <td></td> <td>33.Orchard</td> </tr> <tr> <td></td> <td></td> <td></td> <td></td> <td>%</td> <td></td> <td>34.Softwood F&amp;O</td> </tr> <tr> <td></td> <td></td> <td></td> <td></td> <td>%</td> <td></td> <td>35.Mixed Wood F&amp;O</td> </tr> <tr> <td></td> <td></td> <td></td> <td></td> <td>%</td> <td></td> <td>36.Hardwood F&amp;O</td> </tr> <tr> <td></td> <td></td> <td></td> <td></td> <td>%</td> <td></td> <td>37.Softwood TG</td> </tr> <tr> <td></td> <td></td> <td></td> <td></td> <td>%</td> <td></td> <td>38.Mixed Wood TG</td> </tr> <tr> <td></td> <td></td> <td></td> <td></td> <td>%</td> <td></td> <td>39.Hardwood TG</td> </tr> <tr> <td></td> <td></td> <td></td> <td></td> <td>%</td> <td></td> <td>40.Wasteland</td> </tr> <tr> <td></td> <td></td> <td></td> <td></td> <td>%</td> <td></td> <td>41.Commercial</td> </tr> <tr> <td></td> <td></td> <td></td> <td></td> <td>%</td> <td></td> <td>42.2nd Site</td> </tr> <tr> <td></td> <td></td> <td></td> <td></td> <td>%</td> <td></td> <td>43.Post Rd</td> </tr> <tr> <td></td> <td></td> <td></td> <td></td> <td>%</td> <td></td> <td>44.Lot Improvemen</td> </tr> <tr> <td></td> <td></td> <td></td> <td></td> <td>%</td> <td></td> <td>45.Subdivision Lo</td> </tr> <tr> <td></td> <td></td> <td></td> <td></td> <td>%</td> <td></td> <td>46.Golf Course</td> </tr> </tbody> </table>					Land Data					Front Foot	Type	Effective		Influence		Influence Codes	Frontage	Depth	Factor	Code	11.Road Frontage				%		1.Unimproved	12.Delta Triangle				%		2.Excess Frtg	13.Nabla Triangle				%		3.Topography	14.Rear Land				%		4.Size/Shape	15.Miscellaneous				%		5.Access					%		6.Restriction					%		7.Open Space					%		8.View/Environ					%		9.Fract Share					%		Acres					%		30.Rear Land 3					%		31.Tillable					%		32.Pasture					%		33.Orchard					%		34.Softwood F&O					%		35.Mixed Wood F&O					%		36.Hardwood F&O					%		37.Softwood TG					%		38.Mixed Wood TG					%		39.Hardwood TG					%		40.Wasteland					%		41.Commercial					%		42.2nd Site					%		43.Post Rd					%		44.Lot Improvemen					%		45.Subdivision Lo					%		46.Golf Course
			Land Data																																																																																																																																																																																																																				
Front Foot	Type	Effective		Influence		Influence Codes																																																																																																																																																																																																																	
		Frontage	Depth	Factor	Code																																																																																																																																																																																																																		
11.Road Frontage				%		1.Unimproved																																																																																																																																																																																																																	
12.Delta Triangle				%		2.Excess Frtg																																																																																																																																																																																																																	
13.Nabla Triangle				%		3.Topography																																																																																																																																																																																																																	
14.Rear Land				%		4.Size/Shape																																																																																																																																																																																																																	
15.Miscellaneous				%		5.Access																																																																																																																																																																																																																	
				%		6.Restriction																																																																																																																																																																																																																	
				%		7.Open Space																																																																																																																																																																																																																	
				%		8.View/Environ																																																																																																																																																																																																																	
				%		9.Fract Share																																																																																																																																																																																																																	
				%		Acres																																																																																																																																																																																																																	
				%		30.Rear Land 3																																																																																																																																																																																																																	
				%		31.Tillable																																																																																																																																																																																																																	
				%		32.Pasture																																																																																																																																																																																																																	
				%		33.Orchard																																																																																																																																																																																																																	
				%		34.Softwood F&O																																																																																																																																																																																																																	
				%		35.Mixed Wood F&O																																																																																																																																																																																																																	
				%		36.Hardwood F&O																																																																																																																																																																																																																	
				%		37.Softwood TG																																																																																																																																																																																																																	
				%		38.Mixed Wood TG																																																																																																																																																																																																																	
				%		39.Hardwood TG																																																																																																																																																																																																																	
				%		40.Wasteland																																																																																																																																																																																																																	
				%		41.Commercial																																																																																																																																																																																																																	
				%		42.2nd Site																																																																																																																																																																																																																	
				%		43.Post Rd																																																																																																																																																																																																																	
				%		44.Lot Improvemen																																																																																																																																																																																																																	
				%		45.Subdivision Lo																																																																																																																																																																																																																	
				%		46.Golf Course																																																																																																																																																																																																																	
			TG PLAN YEAR 0																																																																																																																																																																																																																				
			Tif District # 0																																																																																																																																																																																																																				
			Sale Data																																																																																																																																																																																																																				
			Sale Date																																																																																																																																																																																																																				
			Price																																																																																																																																																																																																																				
			Sale Type																																																																																																																																																																																																																				
			1.Land 4.Mobile 7.C/I L&B																																																																																																																																																																																																																				
			2.L & B 5.Other 8.																																																																																																																																																																																																																				
			3.Building 6.C/I Land 9.																																																																																																																																																																																																																				
			Financing																																																																																																																																																																																																																				
			1.Convent 4.Seller 7.																																																																																																																																																																																																																				
			2.FHA/VA 5.Private 8.																																																																																																																																																																																																																				
			3.Assumed 6.Cash 9.Unknown																																																																																																																																																																																																																				
			Validity																																																																																																																																																																																																																				
			1.Valid 4.Split 7.Renovate																																																																																																																																																																																																																				
			2.Related 5.Partial 8.Other																																																																																																																																																																																																																				
			3.Distress 6.Exempt 9.Short																																																																																																																																																																																																																				
			Verified																																																																																																																																																																																																																				
			1.Buyer 4.Agent 7.Family																																																																																																																																																																																																																				
			2.Seller 5.Pub Rec 8.Other																																																																																																																																																																																																																				
			3.Lender 6.MLS 9.																																																																																																																																																																																																																				
			Fract. Acre																																																																																																																																																																																																																				
			21.Base 1 (Fract)																																																																																																																																																																																																																				
			22.Base 2 (Fract)																																																																																																																																																																																																																				
			23.Base 3																																																																																																																																																																																																																				
			Acres																																																																																																																																																																																																																				
			24.Base 1																																																																																																																																																																																																																				
			25.Base 2																																																																																																																																																																																																																				
			26.Frontage 1																																																																																																																																																																																																																				
			27.Rear Land 4																																																																																																																																																																																																																				
			28.Rear Land 1																																																																																																																																																																																																																				
			29.Rear Land 2																																																																																																																																																																																																																				
			Square Foot																																																																																																																																																																																																																				
			16.Regular Lot																																																																																																																																																																																																																				
			17.Secondary Lot																																																																																																																																																																																																																				
			18.Hydro Facility																																																																																																																																																																																																																				
			19.Improvements																																																																																																																																																																																																																				
			20.Base 3 (Fract)																																																																																																																																																																																																																				
			Fract. Acre																																																																																																																																																																																																																				
			21.Base 1 (Fract)																																																																																																																																																																																																																				
			22.Base 2 (Fract)																																																																																																																																																																																																																				
			23.Base 3																																																																																																																																																																																																																				
			Acres																																																																																																																																																																																																																				
			24.Base 1																																																																																																																																																																																																																				
			25.Base 2																																																																																																																																																																																																																				
			26.Frontage 1																																																																																																																																																																																																																				
			27.Rear Land 4																																																																																																																																																																																																																				
			28.Rear Land 1																																																																																																																																																																																																																				
			29.Rear Land 2																																																																																																																																																																																																																				
			Fract. Acre																																																																																																																																																																																																																				
			21.Base 1 (Fract)																																																																																																																																																																																																																				
			22.Base 2 (Fract)																																																																																																																																																																																																																				
			23.Base 3																																																																																																																																																																																																																				
			Acres																																																																																																																																																																																																																				
			24.Base 1																																																																																																																																																																																																																				
			25.Base 2																																																																																																																																																																																																																				
			26.Frontage 1																																																																																																																																																																																																																				
			27.Rear Land 4																																																																																																																																																																																																																				
			28.Rear Land 1																																																																																																																																																																																																																				
			29.Rear Land 2																																																																																																																																																																																																																				
			Fract. Acre																																																																																																																																																																																																																				
			21.Base 1 (Fract)																																																																																																																																																																																																																				
			22.Base 2 (Fract)																																																																																																																																																																																																																				
			23.Base 3																																																																																																																																																																																																																				
			Acres																																																																																																																																																																																																																				
			24.Base 1																																																																																																																																																																																																																				
			25.Base 2																																																																																																																																																																																																																				
			26.Frontage 1																																																																																																																																																																																																																				
			27.Rear Land 4																																																																																																																																																																																																																				
			28.Rear Land 1																																																																																																																																																																																																																				
			29.Rear Land 2																																																																																																																																																																																																																				
			Fract. Acre																																																																																																																																																																																																																				
			21.Base 1 (Fract)																																																																																																																																																																																																																				
			22.Base 2 (Fract)																																																																																																																																																																																																																				
			23.Base 3																																																																																																																																																																																																																				
			Acres																																																																																																																																																																																																																				
			24.Base 1																																																																																																																																																																																																																				
			25.Base 2																																																																																																																																																																																																																				
			26.Frontage 1																																																																																																																																																																																																																				
			27.Rear Land 4																																																																																																																																																																																																																				
			28.Rear Land 1																																																																																																																																																																																																																				
			29.Rear Land 2																																																																																																																																																																																																																				
			Fract. Acre																																																																																																																																																																																																																				
			21.Base 1 (Fract)																																																																																																																																																																																																																				
			22.Base 2 (Fract)																																																																																																																																																																																																																				
			23.Base 3																																																																																																																																																																																																																				
			Acres																																																																																																																																																																																																																				
			24.Base 1																																																																																																																																																																																																																				
			25.Base 2																																																																																																																																																																																																																				
			26.Frontage 1																																																																																																																																																																																																																				
			27.Rear Land 4																																																																																																																																																																																																																				
			28.Rear Land 1																																																																																																																																																																																																																				
			29.Rear Land 2																																																																																																																																																																																																																				
			Fract. Acre																																																																																																																																																																																																																				
			21.Base 1 (Fract)																																																																																																																																																																																																																				
			22.Base 2 (Fract)																																																																																																																																																																																																																				
			23.Base 3																																																																																																																																																																																																																				
			Acres																																																																																																																																																																																																																				
			24.Base 1																																																																																																																																																																																																																				
			25.Base 2																																																																																																																																																																																																																				
			26.Frontage 1																																																																																																																																																																																																																				
			27.Rear Land 4																																																																																																																																																																																																																				
			28.Rear Land 1																																																																																																																																																																																																																				
			29.Rear Land 2																																																																																																																																																																																																																				
			Fract. Acre																																																																																																																																																																																																																				
			21.Base 1 (Fract)																																																																																																																																																																																																																				
			22.Base 2 (Fract)																																																																																																																																																																																																																				
			23.Base 3																																																																																																																																																																																																																				
			Acres																																																																																																																																																																																																																				
			24.Base 1																																																																																																																																																																																																																				
			25.Base 2																																																																																																																																																																																																																				
			26.Frontage 1																																																																																																																																																																																																																				
			27.Rear Land 4																																																																																																																																																																																																																				
			28.Rear Land 1																																																																																																																																																																																																																				
			29.Rear Land 2																																																																																																																																																																																																																				
			Fract. Acre																																																																																																																																																																																																																				
			21.Base 1 (Fract)																																																																																																																																																																																																																				
			22.Base 2 (Fract)																																																																																																																																																																																																																				
			23.Base 3																																																																																																																																																																																																																				
			Acres																																																																																																																																																																																																																				
			24.Base 1																																																																																																																																																																																																																				
			25.Base 2																																																																																																																																																																																																																				
			26.Frontage 1																																																																																																																																																																																																																				
			27.Rear Land 4																																																																																																																																																																																																																				
			28.Rear Land 1																																																																																																																																																																																																																				
			29.Rear Land 2																																																																																																																																																																																																																				
			Fract. Acre																																																																																																																																																																																																																				
			21.Base 1 (Fract)																																																																																																																																																																																																																				
			22.Base 2 (Fract)																																																																																																																																																																																																																				
			23.Base 3																																																																																																																																																																																																																				
			Acres																																																																																																																																																																																																																				
			24.Base 1																																																																																																																																																																																																																				
			25.Base 2																																																																																																																																																																																																																				
			26.Frontage 1																																																																																																																																																																																																																				
			27.Rear Land 4																																																																																																																																																																																																																				
			28.Rear Land 1																																																																																																																																																																																																																				
			29.Rear Land 2																																																																																																																																																																																																																				
			Fract. Acre																																																																																																																																																																																																																				
			21.Base 1 (Fract)																																																																																																																																																																																																																				
			22.Base 2 (Fract)																																																																																																																																																																																																																				
			23.Base 3																																																																																																																																																																																																																				
			Acres																																																																																																																																																																																																																				
			24.Base 1																																																																																																																																																																																																																				
			25.Base 2																																																																																																																																																																																																																				
			26.Frontage 1																																																																																																																																																																																																																				
			27.Rear Land 4																																																																																																																																																																																																																				
			28.Rear Land 1																																																																																																																																																																																																																				
			29.Rear Land 2																																																																																																																																																																																																																				
			Fract. Acre																																																																																																																																																																																																																				
			21.Base 1 (Fract)																																																																																																																																																																																																																				
			22.Base 2 (Fract)																																																																																																																																																																																																																				
			23.Base 3																																																																																																																																																																																																																				
			Acres																																																																																																																																																																																																																				
			24.Base 1																																																																																																																																																																																																																				
			25.Base 2																																																																																																																																																																																																																				
			26.Frontage 1																																																																																																																																																																																																																				
			27.Rear Land 4																																																																																																																																																																																																																				
			28.Rear Land 1																																																																																																																																																																																																																				
			29.Rear Land 2																																																																																																																																																																																																																				
			Fract. Acre																																																																																																																																																																																																																				
			21.Base 1 (Fract)																																																																																																																																																																																																																				
			22.Base 2 (Fract)																																																																																																																																																																																																																				
			23.Base 3																																																																																																																																																																																																																				
			Acres																																																																																																																																																																																																																				
			24.Base 1																																																																																																																																																																																																																				
			25.Base 2																																																																																																																																																																																																																				
			26.Frontage 1																																																																																																																																																																																																																				
			27.Rear Land 4																																																																																																																																																																																																																				
			28.Rear Land 1																																																																																																																																																																																																																				
			29.Rear Land 2																																																																																																																																																																																																																				
			Fract. Acre																																																																																																																																																																																																																				
			21.Base 1 (Fract)																																																																																																																																																																																																																				
			22.Base 2 (Fract)																																																																																																																																																																																																																				
			23.Base 3																																																																																																																																																																																																																				
			Acres																																																																																																																																																																																																																				
			24.Base 1																																																																																																																																																																																																																				
			25.Base 2																																																																																																																																																																																																																				
			26.Frontage 1																																																																																																																																																																																																																				
			27.Rear Land 4																																																																																																																																																																																																																				
			28.Rear Land 1																																																																																																																																																																																																																				
			29.Rear Land 2																																																																																																																																																																																																																				
			Fract. Acre																																																																																																																																																																																																																				
			21.Base 1 (Fract)																																																																																																																																																																																																																				
			22.Base 2 (Fract)																																																																																																																																																																																																																				
			23.Base 3																																																																																																																																																																																																																				
			Acres																																																																																																																																																																																																																				
			24.Base 1																																																																																																																																																																																																																				
			25.Base 2																																																																																																																																																																																																																				
			26.Frontage 1																																																																																																																																																																																																																				
			27.Rear Land 4																																																																																																																																																																																																																				
			28.Rear Land 1																																																																																																																																																																																																																				
			29.Rear Land 2																																																																																																																																																																																																																				
			Fract. Acre																																																																																																																																																																																																																				
			21.Base 1 (Fract)																																																																																																																																																																																																																				
			22.Base 2 (Fract)																																																																																																																																																																																																																				
			23.Base 3																																																																																																																																																																																																																				
			Acres																																																																																																																																																																																																																				
			24.Base 1																																																																																																																																																																																																																				
			25.Base 2																																																																																																																																																																																																																				
			26.Frontage 1																																																																																																																																																																																																																				
			27.Rear Land 4																																																																																																																																																																																																																				
			28.Rear Land 1																																																																																																																																																																																																																				
			29.Rear Land 2																																																																																																																																																																																																																				
			Fract. Acre																																																																																																																																																																																																																				
			21.Base 1 (Fract)																																																																																																																																																																																																																				
			22.Base 2 (Fract)																																																																																																																																																																																																																				
			23.Base 3																																																																																																																																																																																																																				
			Acres																																																																																																																																																																																																																				
			24.Base 1																																																																																																																																																																																																																				
			25.Base 2																																																																																																																																																																																																																				
			26.Frontage 1																																																																																																																																																																																																																				
			27.Rear Land 4																																																																																																																																																																																																																				
			28.Rear Land 1																																																																																																																																																																																																																				
			29.Rear Land 2																																																																																																																																																																																																																				
			Fract. Acre																																																																																																																																																																																																																				
			21.Base 1 (Fract)																																																																																																																																																																																																																				
			22.Base 2 (Fract)																																																																																																																																																																																																																				
			23.Base 3																																																																																																																																																																																																																				
			Acres																																																																																																																																																																																																																				
			24.Base 1																																																																																																																																																																																																																				
			25.Base 2																																																																																																																																																																																																																				
			26.Frontage 1																																																																																																																																																																																																																				
			27.Rear Land 4																																																																																																																																																																																																																				
			28.Rear Land 1																																																																																																																																																																																																																				
			29.Rear Land 2																																																																																																																																																																																																																				
			Fract. Acre																																																																																																																																																																																																																				
			21.Base 1 (Fract)																																																																																																																																																																																																																				
			22.Base 2 (Fract)																																																																																																																																																																																																																				
			23.Base 3																																																																																																																																																																																																																				
			Acres																																																																																																																																																																																																																				
			24.Base 1																																																																																																																																																																																																																				
			25.Base 2																																																																																																																																																																																																																				
			26.Frontage 1																																																																																																																																																																																																																				
			27.Rear Land 4																																																																																																																																																																																																																				
			28.Rear Land 1																																																																																																																																																																																																																				
			29.Rear Land 2																																																																																																																																																																																																																				
			Fract. Acre																																																																																																																																																																																																																				
			21.Base 1 (Fract)																																																																																																																																																																																																																				
			22.Base 2 (Fract)																																																																																																																																																																																																																				
			23.Base 3																																																																																																																																																																																																																				
			Acres																																																																																																																																																																																																																				
			24.Base 1																																																																																																																																																																																																																				
			25.Base 2																																																																																																																																																																																																																				
			26.Frontage 1																																																																																																																																																																																																																				
			27.Rear Land 4																																																																																																																																																																																																																				
			28.Rear Land 1																																																																																																																																																																																																																				
			29.Rear Land 2																																																																																																																																																																																																																				

**Bowdoin**

Map Lot 09-17-01

Account 947

Location 320 WEST RD

Card 1 Of 1 7/19/2022

Building Style <b>0 Not Coded</b>	SF Bsmt Living <b>0</b>	Layout <b>0</b>
0.Not Code 4.Cape 8.Log	Fin Bsmt Grade <b>0 0</b>	1.Typical 4. 7.
1.Conv. 5.Garrison 9.Other	OCCUPANCY <b>0</b>	2.Inadeq 5. 8.
2.Ranch 6.Split 10.DW	Heat Type <b>100% 0 Not Coded</b>	3.Poor 6. 9.
3.R Ranch 7.Contemp 11.Church	0.Not Code 4.Steam 8.FI/Wall	Attic <b>0</b>
Dwelling Units <b>0</b>	1.HWBB 5.FWA 9.No Heat	1.1/4 Fin 4.Full Fin 7.
Other Units <b>0</b>	2.HWCI 6.GravWA 11.	2.1/2 Fin 5.FI/Stair 8.
Stories <b>0</b>	3.H Pump 7.Electric 12.	3.3/4 Fin 6. 9.None
1.1 4.1.5 7.4	Cool Type <b>0% 9 None</b>	Insulation <b>0</b>
2.2 5.1.75 8.20	1.Refrig 4.W&C Air 7.	1.Full 4.Minimal 7.
3.3 6.2.5 9.Yurt	2.Evapor 5. 8.	2.Heavy 5. 8.
Exterior Walls <b>0 Not Coded</b>	3.H Pump 6. 9.None	3.Capped 6. 9.None
0.Not Code 4.Asbestos 8.Concrete	Kitchen Style <b>0</b>	Unfinished % <b>0%</b>
1.Wood 5.Stucco 9.Other	1.Modern 4.Obsolete 7.	Grade & Factor <b>0 0%</b>
2.Vin/Al 6.Brick 10.Board B	2.Typical 5. 8.	1.E Grade 4.B Grade 7.
3.Compos. 7.Stone 12.	3.Old Type 6. 9.None	2.D Grade 5.A Grade 8.
Roof Surface <b>0</b>	Bath(s) Style <b>0</b>	3.C Grade 6.AA Grade 9.Same
1.Asphalt 4.Composit 7.	1.Modern 4.Obsolete 7.	SQFT (Footprint) <b>0</b>
2.Slate 5.Wood 8.	2.Typical 5. 8.	Condition <b>0</b>
3.Metal 6.Other 9.	3.Old Type 6. 9.None	1.Poor 4.Avg 7.V G
SF Masonry Trim <b>0</b>	# Rooms <b>0</b>	2.Fair 5.Avg+ 8.Exc
SEPTIC DESIGN <b>0</b>	# Bedrooms <b>0</b>	3.Avg- 6.Good 9.Same
BLDG PERMIT <b>0</b>	# Full Baths <b>0</b>	Phys. % Good <b>0%</b>
Year Built <b>0</b>	# Half Baths <b>0</b>	Funct. % Good <b>100%</b>
Year Remodeled <b>0</b>	# Addn Fixtures <b>0</b>	Functional Code <b>9 None</b>
Foundation <b>0</b>	# Fireplaces <b>0</b>	1.Incomp 4.Delap 7.No Power
1.Concrete 4.Wood 7.		2.O-Built 5.Bsmt 8.LongTerm
2.C Block 5.Slab 8.		3.Damage 6.Dbwd 9.None
3.Br/Stone 6.Piers 9.		Econ. % Good <b>100%</b>
Basement <b>0</b>		Economic Code <b>None</b>
1.1/4 Bmt 4.Full Bmt 7.		0.None 3.No Power 7.
2.1/2 Bmt 5.None 8.		1.Location 4.Generate 8.
3.3/4 Bmt 6. 9.None		2.Encroach 9.None 9.
Bsmt Gar # Cars <b>0</b>		Entrance Code <b>0</b>
Wet Basement <b>0</b>		1.Interior 4.Vacant 7.Entered
1.Dry 4. 7.		2.Refusal 5.Estimate 8.No
2.Damp 5. 8.		3.Informed 6.Reviewed 9.Land
3.Wet 6. 9.		Information Code <b>0</b>
		1.Owner 4.Agent 7.
		2.Relative 5.Estimate 8.
		3.Tenant 6.Other 9.



Date Inspected

Additions, Outbuildings & Improvements							
Type	Year	Units	Grade	Cond	Phys.	Funct.	Sound Value
					%	%	1.One Story Fram
					%	%	2.Two Story Fram
					%	%	3.Three Story Fr
					%	%	4.1 & 1/2 Story
					%	%	5.1 & 3/4 Story
					%	%	6.2 & 1/2 Story
					%	%	21.Open Frame Por
					%	%	22.Encl Frame Por
					%	%	23.Attached Garag
					%	%	24.Frame Shed
					%	%	25.Frame Bay Wind
					%	%	26.1SFr Overhang
					%	%	27.Unfin Basement
					%	%	28.Unfinished Att
					%	%	29.Finished Attic



BOWDOIN, TOWN OF  
P.O. BOX 35  
BOWDOIN ME 04287

B2511P108

Previous Owner  
GOULD, WAYNE  
P.O. BOX 15

BOWDOIN ME 04287  
Sale Date: 11/29/2010

Inspection Witnessed By:

X	Date
No./Date	Description

Notes:

**Bowdoin**

Property Data			Assessment Record						
Neighborhood <b>9 Map 9</b>			Year	Land	Buildings	Exempt	Total		
Tree Growth Year <b>0</b>			2009	11,680	0	0	11,680		
Farmland Yr <b>0</b>			2010	11,680	0	11,680	0		
Open Space Yr <b>0</b>			2013	11,680	0	11,680	0		
Zone/Land Use <b>11 Residential 1</b>			2014	11,680	0	11,680	0		
Secondary Zone			2015	11,680	0	11,680	0		
Topography			2016	11,680	0	11,680	0		
1.Level 4.Below St 7.LevelBog			2017	11,680	0	11,680	0		
2.Rolling 5.Low 8.Conform			2018	11,680	0	11,680	0		
3.Above St 6.FZone 9.Non-Confor			2019	11,680	0	11,680	0		
Utilities			2020	11,680	0	11,680	0		
1.Public 4.Dr Well 7.Cesspool			2021	11,680	0	11,680	0		
2.Water 5.Dug Well 8.			2022	11,680	0	11,680	0		
3.Sewer 6.Septic 9.None									
Street <b>1 Paved</b>									
1.Paved 4.Proposed 7.MHG			<b>Land Data</b>						
2.Semi Imp 5.R/O/W 8.DIS									
3.Gravel 6.MHP 9.None			<b>Front Foot</b>	<b>Type</b>	<b>Effective</b>		<b>Influence</b>		<b>Influence Codes</b>
TG PLAN YEAR <b>0</b>			11.Road Frontage		<b>Frontage</b>	<b>Depth</b>	<b>Factor</b>	<b>Code</b>	
Tif District # <b>0</b>			12.Delta Triangle				%		1.Unimproved
<b>Sale Data</b>			13.Nabla Triangle				%		2.Excess Frtg
Sale Date <b>11/29/2010</b>			14.Rear Land				%		3.Topography
Price			15.Miscellaneous				%		4.Size/Shape
Sale Type <b>1 Land Only</b>							%		5.Access
1.Land 4.Mobile 7.C/I L&B			<b>Square Foot</b>		<b>Square Feet</b>				6.Restriction
2.L & B 5.Other 8.			16.Regular Lot				%		7.Open Space
3.Building 6.C/I Land 9.			17.Secondary Lot				%		8.View/Environ
Financing <b>9 Unknown</b>			18.Hydro Facility				%		9.Fract Share
1.Convent 4.Seller 7.			19.Improvements				%		<b>Acres</b>
2.FHA/VA 5.Private 8.			20.Base 3 (Fract)				%		30.Rear Land 3
3.Assumed 6.Cash 9.Unknown							%		31.Tillable
Validity <b>8 Other Non Valid</b>			<b>Fract. Acre</b>		<b>Acres/Sites</b>				32.Pasture
1.Valid 4.Split 7.Renovate			21.Base 1 (Fract)	23		1.00	100 %	0	33.Orchard
2.Related 5.Partial 8.Other			22.Base 2 (Fract)	28		1.20	100 %	0	34.Softwood F&O
3.Distress 6.Exempt 9.Short			23.Base 3				%		35.Mixed Wood F&O
Verified <b>8 Other Source</b>			<b>Acres</b>				%		36.Hardwood F&O
1.Buyer 4.Agent 7.Family			24.Base 1				%		37.Softwood TG
2.Seller 5.Pub Rec 8.Other			25.Base 2				%		38.Mixed Wood TG
3.Lender 6.MLS 9.			26.Frontage 1				%		39.Hardwood TG
			27.Rear Land 4				%		40.Wasteland
			28.Rear Land 1				%		41.Commercial
			29.Rear Land 2				%		42.2nd Site
			<b>Total Acreage</b>		2.20				43.Post Rd
									44.Lot Improvemen
									45.Subdivision Lo
									46.Golf Course

**Bowdoin**

Map Lot 09-17-02

Account 1646

Location WEST RD

Card 1 Of 1 7/19/2022

Building Style <b>0 Not Coded</b>	SF Bsmt Living <b>0</b>	Layout <b>0</b>
0.Not Code 4.Cape 8.Log	Fin Bsmt Grade <b>0 0</b>	1.Typical 4. 7.
1.Conv. 5.Garrison 9.Other	OCCUPANCY <b>0</b>	2.Inadeq 5. 8.
2.Ranch 6.Split 10.DW	Heat Type <b>100% 0 Not Coded</b>	3.Poor 6. 9.
3.R Ranch 7.Contemp 11.Church	0.Not Code 4.Steam 8.FI/Wall	Attic <b>0</b>
Dwelling Units <b>0</b>	1.HWBB 5.FWA 9.No Heat	1.1/4 Fin 4.Full Fin 7.
Other Units <b>0</b>	2.HWCI 6.GravWA 11.	2.1/2 Fin 5.FI/Stair 8.
Stories <b>0</b>	3.H Pump 7.Electric 12.	3.3/4 Fin 6. 9.None
1.1 4.1.5 7.4	Cool Type <b>0% 9 None</b>	Insulation <b>0</b>
2.2 5.1.75 8.20	1.Refrig 4.W&C Air 7.	1.Full 4.Minimal 7.
3.3 6.2.5 9.Yurt	2.Evapor 5. 8.	2.Heavy 5. 8.
Exterior Walls <b>0 Not Coded</b>	3.H Pump 6. 9.None	3.Capped 6. 9.None
0.Not Code 4.Asbestos 8.Concrete	Kitchen Style <b>0</b>	Unfinished % <b>0%</b>
1.Wood 5.Stucco 9.Other	1.Modern 4.Obsolete 7.	Grade & Factor <b>0 0%</b>
2.Vin/Al 6.Brick 10.Board B	2.Typical 5. 8.	1.E Grade 4.B Grade 7.
3.Compos. 7.Stone 12.	3.Old Type 6. 9.None	2.D Grade 5.A Grade 8.
Roof Surface <b>0</b>	Bath(s) Style <b>0</b>	3.C Grade 6.AA Grade 9.Same
1.Asphalt 4.Composit 7.	1.Modern 4.Obsolete 7.	SQFT (Footprint) <b>0</b>
2.Slate 5.Wood 8.	2.Typical 5. 8.	Condition <b>0</b>
3.Metal 6.Other 9.	3.Old Type 6. 9.None	1.Poor 4.Avg 7.V G
SF Masonry Trim <b>0</b>	# Rooms <b>0</b>	2.Fair 5.Avg+ 8.Exc
SEPTIC DESIGN <b>0</b>	# Bedrooms <b>0</b>	3.Avg- 6.Good 9.Same
BLDG PERMIT <b>0</b>	# Full Baths <b>0</b>	Phys. % Good <b>0%</b>
Year Built <b>0</b>	# Half Baths <b>0</b>	Funct. % Good <b>100%</b>
Year Remodeled <b>0</b>	# Addn Fixtures <b>0</b>	Functional Code <b>9 None</b>
Foundation <b>0</b>	# Fireplaces <b>0</b>	1.Incomp 4.Delap 7.No Power
1.Concrete 4.Wood 7.		2.O-Built 5.Bsmt 8.LongTerm
2.C Block 5.Slab 8.		3.Damage 6.Dbwd 9.None
3.Br/Stone 6.Piers 9.		Econ. % Good <b>100%</b>
Basement <b>0</b>		Economic Code <b>None</b>
1.1/4 Bmt 4.Full Bmt 7.		0.None 3.No Power 7.
2.1/2 Bmt 5.None 8.		1.Location 4.Generate 8.
3.3/4 Bmt 6. 9.None		2.Encroach 9.None 9.
Bsmt Gar # Cars <b>0</b>		Entrance Code <b>0</b>
Wet Basement <b>0</b>		1.Interior 4.Vacant 7.Entered
1.Dry 4. 7.		2.Refusal 5.Estimate 8.No
2.Damp 5. 8.		3.Informed 6.Reviewed 9.Land
3.Wet 6. 9.		Information Code <b>0</b>
		1.Owner 4.Agent 7.
		2.Relative 5.Estimate 8.
		3.Tenant 6.Other 9.



Date Inspected

Additions, Outbuildings & Improvements							
Type	Year	Units	Grade	Cond	Phys.	Funct.	Sound Value
					%	%	1.One Story Fram
					%	%	2.Two Story Fram
					%	%	3.Three Story Fr
					%	%	4.1 & 1/2 Story
					%	%	5.1 & 3/4 Story
					%	%	6.2 & 1/2 Story
					%	%	21.Open Frame Por
					%	%	22.Encl Frame Por
					%	%	23.Attached Garag
					%	%	24.Frame Shed
					%	%	25.Frame Bay Wind
					%	%	26.1SFr Overhang
					%	%	27.Unfin Basement
					%	%	28.Unfinished Att
					%	%	29.Finished Attic

CEMETERY ASSOCIATION, WOODLAWN  
BOWDOIN ME 04287

B2567P194

Inspection Witnessed By:

No./Date	Description	Date Insp.
X		

Notes:

**Bowdoin**

Property Data			Assessment Record						
Neighborhood <b>20 Cemetery</b>			Year	Land	Buildings	Exempt	Total		
Tree Growth Year <b>0</b>			2009	11,820	0	11,820	0		
Farmland Yr <b>0</b>			2010	11,820	0	11,820	0		
Open Space Yr <b>0</b>			2013	11,820	0	11,820	0		
Zone/Land Use <b>11 Residential 1</b>			2014	11,820	0	11,820	0		
Secondary Zone			2015	11,820	0	11,820	0		
Topography			2016	11,820	0	11,820	0		
1.Level 4.Below St 7.LevelBog			2017	11,820	0	11,820	0		
2.Rolling 5.Low 8.Conform			2018	11,820	0	11,820	0		
3.Above St 6.FZone 9.Non-Confor			2019	11,820	0	11,820	0		
Utilities			2020	11,820	0	11,820	0		
1.Public 4.Dr Well 7.Cesspool			2021	11,820	0	11,820	0		
2.Water 5.Dug Well 8.			2022	11,820	0	11,820	0		
3.Sewer 6.Septic 9.None									
Street <b>1 Paved</b>									
1.Paved 4.Proposed 7.MHG			<b>Land Data</b>						
2.Semi Imp 5.R/O/W 8.DIS									
3.Gravel 6.MHP 9.None			<b>Front Foot</b>	<b>Type</b>	<b>Effective</b>		<b>Influence</b>		<b>Influence Codes</b>
TG PLAN YEAR <b>0</b>			11.Road Frontage		<b>Frontage</b>	<b>Depth</b>	<b>Factor</b>	<b>Code</b>	
Tif District # <b>0</b>			12.Delta Triangle				%		1.Unimproved
<b>Sale Data</b>			13.Nabla Triangle				%		2.Excess Frtg
Sale Date <b>5/25/2005</b>			14.Rear Land				%		3.Topography
Price			15.Miscellaneous				%		4.Size/Shape
Sale Type <b>5 Other</b>							%		5.Access
1.Land 4.Mobile 7.C/I L&B			<b>Square Foot</b>		<b>Square Feet</b>				6.Restriction
2.L & B 5.Other 8.			16.Regular Lot				%		7.Open Space
3.Building 6.C/I Land 9.			17.Secondary Lot				%		8.View/Environ
Financing			18.Hydro Facility				%		9.Fract Share
1.Convent 4.Seller 7.			19.Improvements				%		<b>Acres</b>
2.FHA/VA 5.Private 8.			20.Base 3 (Fract)				%		30.Rear Land 3
3.Assumed 6.Cash 9.Unknown							%		31.Tillable
Validity <b>6 Exempt Property</b>			<b>Fract. Acre</b>		<b>Acres/Sites</b>				32.Pasture
1.Valid 4.Split 7.Renovate			21.Base 1 (Fract)	23		1.00	100 %	0	33.Orchard
2.Related 5.Partial 8.Other			22.Base 2 (Fract)	28		1.30	100 %	0	34.Softwood F&O
3.Distress 6.Exempt 9.Short			23.Base 3				%		35.Mixed Wood F&O
Verified			<b>Acres</b>				%		36.Hardwood F&O
1.Buyer 4.Agent 7.Family			24.Base 1				%		37.Softwood TG
2.Seller 5.Pub Rec 8.Other			25.Base 2				%		38.Mixed Wood TG
3.Lender 6.MLS 9.			26.Frontage 1				%		39.Hardwood TG
			27.Rear Land 4				%		40.Wasteland
			28.Rear Land 1				%		41.Commercial
			29.Rear Land 2				%		42.2nd Site
			<b>Total Acreage</b>		2.30				43.Post Rd
									44.Lot Improvemen
									45.Subdivision Lo
									46.Golf Course

**Bowdoin**

Map Lot 09-17-03

Account 1674

Location WEST RD

Card 1 Of 1 7/19/2022

Building Style			SF Bsmt Living			Layout		
0.Not Code	4.Cape	8.Log	Fin Bsmt Grade			1.Typical	4.	7.
1.Conv.	5.Garrison	9.Other	OCCUPANCY			2.Inadeq	5.	8.
2.Ranch	6.Split	10.DW	Heat Type <b>100%</b>			3.Poor	6.	9.
3.R Ranch	7.Contemp	11.Church	0.Not Code	4.Steam	8.FI/Wall	Attic		
Dwelling Units			1.HWBB	5.FWA	9.No Heat	1.1/4 Fin	4.Full Fin	7.
Other Units			2.HWCI	6.GravWA	11.	2.1/2 Fin	5.FI/Stair	8.
Stories			3.H Pump	7.Electric	12.	3.3/4 Fin	6.	9.None
1.1	4.1.5	7.4	Cool Type <b>0%</b>			Insulation		
2.2	5.1.75	8.20	1.Refrig	4.W&C Air	7.	1.Full	4.Minimal	7.
3.3	6.2.5	9.Yurt	2.Evapor	5.	8.	2.Heavy	5.	8.
Exterior Walls			3.H Pump	6.	9.None	3.Capped	6.	9.None
0.Not Code	4.Asbestos	8.Concrete	Kitchen Style			Unfinished %		
1.Wood	5.Stucco	9.Other	1.Modern	4.Obsolete	7.	Grade & Factor		
2.Vin/Al	6.Brick	10.Board B	2.Typical	5.	8.	1.E Grade	4.B Grade	7.
3.Compos.	7.Stone	12.	3.Old Type	6.	9.None	2.D Grade	5.A Grade	8.
Roof Surface			Bath(s) Style			3.C Grade	6.AA Grade	9.Same
1.Asphalt	4.Composit	7.	1.Modern	4.Obsolete	7.	SQFT (Footprint)		
2.Slate	5.Wood	8.	2.Typical	5.	8.	Condition		
3.Metal	6.Other	9.	3.Old Type	6.	9.None	1.Poor	4.Avg	7.V G
SF Masonry Trim			# Rooms			2.Fair	5.Avg+	8.Exc
SEPTIC DESIGN			# Bedrooms			3.Avg-	6.Good	9.Same
BLDG PERMIT			# Full Baths			Phys. % Good		
Year Built			# Half Baths			Funct. % Good		
Year Remodeled			# Addn Fixtures			Functional Code		
Foundation			# Fireplaces			1.Incomp	4.Delap	7.No Power
1.Concrete	4.Wood	7.						
2.C Block	5.Slab	8.						
3.Br/Stone	6.Piers	9.						
Basement								
1.1/4 Bmt	4.Full Bmt	7.						
2.1/2 Bmt	5.None	8.						
3.3/4 Bmt	6.	9.None						
Bsmt Gar # Cars								
Wet Basement								
1.Dry	4.	7.						
2.Damp	5.	8.						
3.Wet	6.	9.						
Date Inspected			Econ. % Good			Economic Code		
						0.None	3.No Power	7.
						1.Location	4.Generate	8.
						2.Encroach	9.None	9.
						Entrance Code <b>0</b>		
						1.Interior	4.Vacant	7.Entered
						2.Refusal	5.Estimate	8.No
						3.Informed	6.Reviewed	9.Land
						Information Code <b>0</b>		
						1.Owner	4.Agent	7.
						2.Relative	5.Estimate	8.
						3.Tenant	6.Other	9.

Additions, Outbuildings & Improvements							
Type	Year	Units	Grade	Cond	Phys.	Funct.	Sound Value
					%	%	
					%	%	
					%	%	
					%	%	
					%	%	
					%	%	
					%	%	
					%	%	
					%	%	
					%	%	





**Bowdoin**

Map Lot 09-17-04

Account 1788

Location 280 WEST RD

Card 1

Of 1

7/19/2022

Building Style	SF Bsmt Living	Layout
0.Not Code 4.Cape 8.Log	Fin Bsmt Grade	1.Typical 4. 7.
1.Conv. 5.Garrison 9.Other	OCCUPANCY	2.Inadeq 5. 8.
2.Ranch 6.Split 10.DW	Heat Type <b>100%</b>	3.Poor 6. 9.
3.R Ranch 7.Contemp 11.Church	0.Not Code 4.Steam 8.FI/Wall	Attic
Dwelling Units	1.HWBB 5.FWA 9.No Heat	1.1/4 Fin 4.Full Fin 7.
Other Units	2.HWCI 6.GravWA 11.	2.1/2 Fin 5.FI/Stair 8.
Stories	3.H Pump 7.Electric 12.	3.3/4 Fin 6. 9.None
1.1 4.1.5 7.4	Cool Type <b>0%</b>	Insulation
2.2 5.1.75 8.20	1.Refrig 4.W&C Air 7.	1.Full 4.Minimal 7.
3.3 6.2.5 9.Yurt	2.Evapor 5. 8.	2.Heavy 5. 8.
Exterior Walls	3.H Pump 6. 9.None	3.Capped 6. 9.None
0.Not Code 4.Asbestos 8.Concrete	Kitchen Style	Unfinished %
1.Wood 5.Stucco 9.Other	1.Modern 4.Obsolete 7.	Grade & Factor
2.Vin/Al 6.Brick 10.Board B	2.Typical 5. 8.	1.E Grade 4.B Grade 7.
3.Compos. 7.Stone 12.	3.Old Type 6. 9.None	2.D Grade 5.A Grade 8.
Roof Surface	Bath(s) Style	3.C Grade 6.AA Grade 9.Same
1.Asphalt 4.Composit 7.	1.Modern 4.Obsolete 7.	SQFT (Footprint)
2.Slate 5.Wood 8.	2.Typical 5. 8.	Condition
3.Metal 6.Other 9.	3.Old Type 6. 9.None	1.Poor 4.Avg 7.V G
SF Masonry Trim	# Rooms	2.Fair 5.Avg+ 8.Exc
SEPTIC DESIGN	# Bedrooms	3.Avg- 6.Good 9.Same
BLDG PERMIT	# Full Baths	Phys. % Good
Year Built	# Half Baths	Funct. % Good
Year Remodeled	# Addn Fixtures	Functional Code
Foundation	# Fireplaces	1.Incomp 4.Delap 7.No Power
1.Concrete 4.Wood 7.		2.O-Built 5.Bsmt 8.LongTerm
2.C Block 5.Slab 8.		3.Damage 6.Dbwd 9.None
3.Br/Stone 6.Piers 9.		Econ. % Good
Basement		Economic Code
1.1/4 Bmt 4.Full Bmt 7.		0.None 3.No Power 7.
2.1/2 Bmt 5.None 8.		1.Location 4.Generate 8.
3.3/4 Bmt 6. 9.None		2.Encroach 9.None 9.
Bsmt Gar # Cars		Entrance Code <b>5 Estimated</b>
Wet Basement		1.Interior 4.Vacant 7.Entered
1.Dry 4. 7.		2.Refusal 5.Estimate 8.No
2.Damp 5. 8.	3.Informed 6.Reviewed 9.Land	
3.Wet 6. 9.	Information Code <b>6 Other</b>	
	1.Owner 4.Agent 7.	
	2.Relative 5.Estimate 8.	
	3.Tenant 6.Other 9.	

Date Inspected 5/11/2022

**Additions, Outbuildings & Improvements**

Type	Year	Units	Grade	Cond	Phys.	Funct.	Sound Value
992 Doublewide	1999	28x56	3 100	3	0 %	100 %	
73 M/H Skirting	2009	168	2 100	2	0 %	100 %	
68 Wood Deck	2010	366	2 100	2	0 %	100 %	
68 Wood Deck	2009	48	2 100	2	0 %	100 %	
24 Frame Shed	2009	127	2 100	2	0 %	100 %	
24 Frame Shed	2009	108	2 100	2	0 %	100 %	
30 Detached Garage	2022	1500	3 100	1	25 %	25 %	
					%	%	
					%	%	
					%	%	

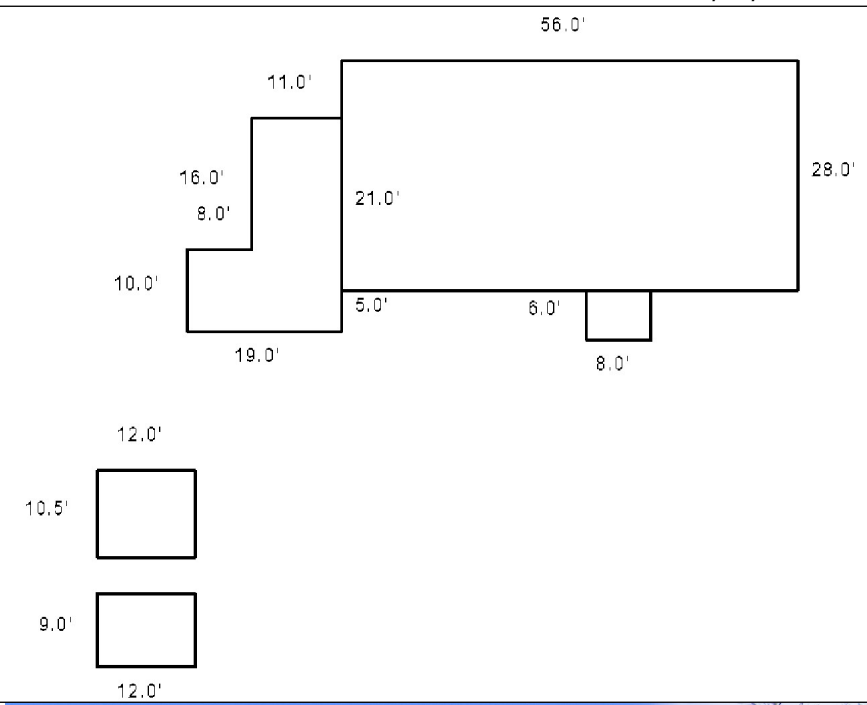

CEMETERY ASSOCIATION, WOODLAWN  
333 WEST BURROUGH RD  
BOWDOIN ME 04287

B2016RP5249

Inspection Witnessed By:

No./Date	Description	Date Insp.
X		

Notes:

**Bowdoin**

Property Data			Assessment Record																																																																																																																																																																																																												
Neighborhood <b>9 Map 9</b>			Year	Land	Buildings	Exempt	Total																																																																																																																																																																																																								
Tree Growth Year <b>0</b>			2017	2,040	0	2,040	0																																																																																																																																																																																																								
Farmland Yr <b>0</b>			2018	2,040	0	2,040	0																																																																																																																																																																																																								
Open Space Yr <b>0</b>			2019	2,040	0	2,040	0																																																																																																																																																																																																								
Zone/Land Use <b>11 Residential 1</b>			2020	2,040	0	2,040	0																																																																																																																																																																																																								
Secondary Zone			2021	2,040	0	2,040	0																																																																																																																																																																																																								
Topography			2022	2,040	0	2,040	0																																																																																																																																																																																																								
1.Level 4.Below St 7.LevelBog 2.Rolling 5.Low 8.Conform 3.Above St 6.FZone 9.Non-Confor																																																																																																																																																																																																															
Utilities																																																																																																																																																																																																															
1.Public 4.Dr Well 7.Cesspool 2.Water 5.Dug Well 8. 3.Sewer 6.Septic 9.None																																																																																																																																																																																																															
Street																																																																																																																																																																																																															
1.Paved 4.Proposed 7.MHG 2.Semi Imp 5.R/O/W 8.DIS 3.Gravel 6.MHP 9.None																																																																																																																																																																																																															
TG PLAN YEAR <b>0</b>			<table border="1"> <thead> <tr> <th rowspan="2">Front Foot</th> <th rowspan="2">Type</th> <th colspan="2">Effective</th> <th colspan="2">Influence</th> <th rowspan="2">Influence Codes</th> </tr> <tr> <th>Frontage</th> <th>Depth</th> <th>Factor</th> <th>Code</th> </tr> </thead> <tbody> <tr> <td>11.Road Frontage</td> <td></td> <td></td> <td></td> <td>%</td> <td></td> <td>1.Unimproved</td> </tr> <tr> <td>12.Delta Triangle</td> <td></td> <td></td> <td></td> <td>%</td> <td></td> <td>2.Excess Frtg</td> </tr> <tr> <td>13.Nabla Triangle</td> <td></td> <td></td> <td></td> <td>%</td> <td></td> <td>3.Topography</td> </tr> <tr> <td>14.Rear Land</td> <td></td> <td></td> <td></td> <td>%</td> <td></td> <td>4.Size/Shape</td> </tr> <tr> <td>15.Miscellaneous</td> <td></td> <td></td> <td></td> <td>%</td> <td></td> <td>5.Access</td> </tr> <tr> <td></td> <td></td> <td></td> <td></td> <td>%</td> <td></td> <td>6.Restriction</td> </tr> <tr> <td></td> <td></td> <td></td> <td></td> <td>%</td> <td></td> <td>7.Open Space</td> </tr> <tr> <td></td> <td></td> <td></td> <td></td> <td>%</td> <td></td> <td>8.View/Environ</td> </tr> <tr> <td></td> <td></td> <td></td> <td></td> <td>%</td> <td></td> <td>9.Fract Share</td> </tr> <tr> <td></td> <td></td> <td></td> <td></td> <td>%</td> <td></td> <td><b>Acres</b></td> </tr> <tr> <td></td> <td></td> <td></td> <td></td> <td>%</td> <td></td> <td>30.Rear Land 3</td> </tr> <tr> <td></td> <td></td> <td></td> <td></td> <td>%</td> <td></td> <td>31.Tillable</td> </tr> <tr> <td></td> <td></td> <td></td> <td></td> <td>%</td> <td></td> <td>32.Pasture</td> </tr> <tr> <td></td> <td></td> <td></td> <td></td> <td>%</td> <td></td> <td>33.Orchard</td> </tr> <tr> <td></td> <td></td> <td></td> <td></td> <td>%</td> <td></td> <td>34.Softwood F&amp;O</td> </tr> <tr> <td></td> <td></td> <td></td> <td></td> <td>%</td> <td></td> <td>35.Mixed Wood F&amp;O</td> </tr> <tr> <td></td> <td></td> <td></td> <td></td> <td>%</td> <td></td> <td>36.Hardwood F&amp;O</td> </tr> <tr> <td></td> <td></td> <td></td> <td></td> <td>%</td> <td></td> <td>37.Softwood TG</td> </tr> <tr> <td></td> <td></td> <td></td> <td></td> <td>%</td> <td></td> <td>38.Mixed Wood TG</td> </tr> <tr> <td></td> <td></td> <td></td> <td></td> <td>%</td> <td></td> <td>39.Hardwood TG</td> </tr> <tr> <td></td> <td></td> <td></td> <td></td> <td>%</td> <td></td> <td>40.Wasteland</td> </tr> <tr> <td></td> <td></td> <td></td> <td></td> <td>%</td> <td></td> <td>41.Commercial</td> </tr> <tr> <td></td> <td></td> <td></td> <td></td> <td>%</td> <td></td> <td>42.2nd Site</td> </tr> <tr> <td></td> <td></td> <td></td> <td></td> <td>%</td> <td></td> <td>43.Post Rd</td> </tr> <tr> <td></td> <td></td> <td></td> <td></td> <td>%</td> <td></td> <td>44.Lot Improvemen</td> </tr> <tr> <td></td> <td></td> <td></td> <td></td> <td>%</td> <td></td> <td>45.Subdivision Lo</td> </tr> <tr> <td></td> <td></td> <td></td> <td></td> <td>%</td> <td></td> <td>46.Golf Course</td> </tr> </tbody> </table>					Front Foot	Type	Effective		Influence		Influence Codes	Frontage	Depth	Factor	Code	11.Road Frontage				%		1.Unimproved	12.Delta Triangle				%		2.Excess Frtg	13.Nabla Triangle				%		3.Topography	14.Rear Land				%		4.Size/Shape	15.Miscellaneous				%		5.Access					%		6.Restriction					%		7.Open Space					%		8.View/Environ					%		9.Fract Share					%		<b>Acres</b>					%		30.Rear Land 3					%		31.Tillable					%		32.Pasture					%		33.Orchard					%		34.Softwood F&O					%		35.Mixed Wood F&O					%		36.Hardwood F&O					%		37.Softwood TG					%		38.Mixed Wood TG					%		39.Hardwood TG					%		40.Wasteland					%		41.Commercial					%		42.2nd Site					%		43.Post Rd					%		44.Lot Improvemen					%		45.Subdivision Lo					%		46.Golf Course
Front Foot	Type	Effective								Influence		Influence Codes																																																																																																																																																																																																			
		Frontage	Depth	Factor	Code																																																																																																																																																																																																										
11.Road Frontage				%		1.Unimproved																																																																																																																																																																																																									
12.Delta Triangle				%		2.Excess Frtg																																																																																																																																																																																																									
13.Nabla Triangle				%		3.Topography																																																																																																																																																																																																									
14.Rear Land				%		4.Size/Shape																																																																																																																																																																																																									
15.Miscellaneous				%		5.Access																																																																																																																																																																																																									
				%		6.Restriction																																																																																																																																																																																																									
				%		7.Open Space																																																																																																																																																																																																									
				%		8.View/Environ																																																																																																																																																																																																									
				%		9.Fract Share																																																																																																																																																																																																									
				%		<b>Acres</b>																																																																																																																																																																																																									
				%		30.Rear Land 3																																																																																																																																																																																																									
				%		31.Tillable																																																																																																																																																																																																									
				%		32.Pasture																																																																																																																																																																																																									
				%		33.Orchard																																																																																																																																																																																																									
				%		34.Softwood F&O																																																																																																																																																																																																									
				%		35.Mixed Wood F&O																																																																																																																																																																																																									
				%		36.Hardwood F&O																																																																																																																																																																																																									
				%		37.Softwood TG																																																																																																																																																																																																									
				%		38.Mixed Wood TG																																																																																																																																																																																																									
				%		39.Hardwood TG																																																																																																																																																																																																									
				%		40.Wasteland																																																																																																																																																																																																									
				%		41.Commercial																																																																																																																																																																																																									
				%		42.2nd Site																																																																																																																																																																																																									
				%		43.Post Rd																																																																																																																																																																																																									
				%		44.Lot Improvemen																																																																																																																																																																																																									
				%		45.Subdivision Lo																																																																																																																																																																																																									
				%		46.Golf Course																																																																																																																																																																																																									
Tif District # <b>0</b>			<b>Land Data</b>																																																																																																																																																																																																												
<b>Sale Data</b>																																																																																																																																																																																																															
Sale Date <b>7/22/2016</b>																																																																																																																																																																																																															
Price <b>2,500</b>																																																																																																																																																																																																															
Sale Type <b>1 Land Only</b>																																																																																																																																																																																																															
1.Land 4.Mobile 7.C/I L&B 2.L & B 5.Other 8. 3.Building 6.C/I Land 9.																																																																																																																																																																																																															
Financing <b>9 Unknown</b>																																																																																																																																																																																																															
1.Convent 4.Seller 7. 2.FHA/VA 5.Private 8. 3.Assumed 6.Cash 9.Unknown																																																																																																																																																																																																															
Validity <b>8 Other Non Valid</b>																																																																																																																																																																																																															
1.Valid 4.Split 7.Renovate 2.Related 5.Partial 8.Other 3.Distress 6.Exempt 9.Short																																																																																																																																																																																																															
Verified <b>5 Public Record</b>																																																																																																																																																																																																															
1.Buyer 4.Agent 7.Family 2.Seller 5.Pub Rec 8.Other 3.Lender 6.MLS 9.																																																																																																																																																																																																															
			<table border="1"> <thead> <tr> <th>Fract. Acre</th> <th colspan="2">Acres/Sites</th> <th colspan="3"></th> </tr> </thead> <tbody> <tr> <td>21.Base 1 (Fract)</td> <td>28</td> <td>1.46</td> <td>100</td> <td>%</td> <td>0</td> </tr> <tr> <td>22.Base 2 (Fract)</td> <td></td> <td></td> <td></td> <td>%</td> <td></td> </tr> <tr> <td>23.Base 3</td> <td></td> <td></td> <td></td> <td>%</td> <td></td> </tr> <tr> <td><b>Acres</b></td> <td></td> <td></td> <td></td> <td>%</td> <td></td> </tr> <tr> <td>24.Base 1</td> <td></td> <td></td> <td></td> <td>%</td> <td></td> </tr> <tr> <td>25.Base 2</td> <td></td> <td></td> <td></td> <td>%</td> <td></td> </tr> <tr> <td>26.Frontage 1</td> <td></td> <td></td> <td></td> <td>%</td> <td></td> </tr> <tr> <td>27.Rear Land 4</td> <td></td> <td></td> <td></td> <td>%</td> <td></td> </tr> <tr> <td>28.Rear Land 1</td> <td></td> <td></td> <td></td> <td>%</td> <td></td> </tr> <tr> <td>29.Rear Land 2</td> <td></td> <td></td> <td></td> <td>%</td> <td></td> </tr> <tr> <td colspan="3"><b>Total Acreage</b></td> <td>1.46</td> <td colspan="2"></td> </tr> </tbody> </table>					Fract. Acre	Acres/Sites					21.Base 1 (Fract)	28	1.46	100	%	0	22.Base 2 (Fract)				%		23.Base 3				%		<b>Acres</b>				%		24.Base 1				%		25.Base 2				%		26.Frontage 1				%		27.Rear Land 4				%		28.Rear Land 1				%		29.Rear Land 2				%		<b>Total Acreage</b>			1.46																																																																																																																																		
Fract. Acre	Acres/Sites																																																																																																																																																																																																														
21.Base 1 (Fract)	28	1.46	100	%	0																																																																																																																																																																																																										
22.Base 2 (Fract)				%																																																																																																																																																																																																											
23.Base 3				%																																																																																																																																																																																																											
<b>Acres</b>				%																																																																																																																																																																																																											
24.Base 1				%																																																																																																																																																																																																											
25.Base 2				%																																																																																																																																																																																																											
26.Frontage 1				%																																																																																																																																																																																																											
27.Rear Land 4				%																																																																																																																																																																																																											
28.Rear Land 1				%																																																																																																																																																																																																											
29.Rear Land 2				%																																																																																																																																																																																																											
<b>Total Acreage</b>			1.46																																																																																																																																																																																																												



**Bowdoin**

Map Lot 09-17-05

Account 1892

Location WEST RD

Card 1 Of 1 7/19/2022

Building Style			SF Bsmt Living			Layout								
0.Not Code	4.Cape	8.Log	Fin Bsmt Grade			1.Typical	4.	7.						
1.Conv.	5.Garrison	9.Other	OCCUPANCY			2.Inadeq	5.	8.						
2.Ranch	6.Split	10.DW	Heat Type <b>100%</b>			3.Poor	6.	9.						
3.R Ranch	7.Contemp	11.Church	0.Not Code	4.Steam	8.FI/Wall	Attic								
Dwelling Units			1.HWBB	5.FWA	9.No Heat	1.1/4 Fin	4.Full Fin	7.						
Other Units			2.HWCI	6.GravWA	11.	2.1/2 Fin	5.FI/Stair	8.						
Stories			3.H Pump	7.Electric	12.	3.3/4 Fin	6.	9.None						
1.1	4.1.5	7.4	Cool Type <b>0%</b>			Insulation								
2.2	5.1.75	8.20	1.Refrig	4.W&C Air	7.	1.Full	4.Minimal	7.						
3.3	6.2.5	9.Yurt	2.Evapor	5.	8.	2.Heavy	5.	8.						
Exterior Walls			3.H Pump	6.	9.None	3.Capped	6.	9.None						
0.Not Code	4.Asbestos	8.Concrete	Kitchen Style			Unfinished %								
1.Wood	5.Stucco	9.Other	1.Modern	4.Obsolete	7.	Grade & Factor								
2.Vin/Al	6.Brick	10.Board B	2.Typical	5.	8.	1.E Grade	4.B Grade	7.						
3.Compos.	7.Stone	12.	3.Old Type	6.	9.None	2.D Grade	5.A Grade	8.						
Roof Surface			Bath(s) Style			3.C Grade	6.AA Grade	9.Same						
1.Asphalt	4.Composit	7.	1.Modern	4.Obsolete	7.	SQFT (Footprint)								
2.Slate	5.Wood	8.	2.Typical	5.	8.	Condition								
3.Metal	6.Other	9.	3.Old Type	6.	9.None	1.Poor	4.Avg	7.V G						
SF Masonry Trim			# Rooms			2.Fair	5.Avg+	8.Exc						
SEPTIC DESIGN			# Bedrooms			3.Avg-	6.Good	9.Same						
BLDG PERMIT			# Full Baths			Phys. % Good								
Year Built			# Half Baths			Funct. % Good								
Year Remodeled			# Addn Fixtures			Functional Code								
Foundation			# Fireplaces			1.Incomp	4.Delap	7.No Power						
1.Concrete	4.Wood	7.							2.O-Built	5.Bsmt	8.LongTerm			
2.C Block	5.Slab	8.							Econ. % Good			3.Damage	6.Dbwd	9.None
3.Br/Stone	6.Piers	9.							Economic Code			Entrance Code <b>0</b>		
Basement									0.None			3.No Power	7.	
1.1/4 Bmt	4.Full Bmt	7.							1.Location			4.Generate	8.	
2.1/2 Bmt	5.None	8.							2.Encroach			9.None	9.	
3.3/4 Bmt	6.	9.None							Information Code <b>0</b>			1.Interior		
Bsmt Gar # Cars									1.Owner			4.Agent	7.	
Wet Basement									2.Relative			5.Estimate	8.	
1.Dry	4.	7.							3.Tenant			6.Other	9.	
2.Damp	5.	8.	Date Inspected											
3.Wet	6.	9.	<b>Additions, Outbuildings &amp; Improvements</b>											
Type	Year	Units	Grade	Cond	Phys.	Funct.	Sound Value							
					%	%		1.One Story Fram						
					%	%		2.Two Story Fram						
					%	%		3.Three Story Fr						
					%	%		4.1 & 1/2 Story						
					%	%		5.1 & 3/4 Story						
					%	%		6.2 & 1/2 Story						
					%	%		21.Open Frame Por						
					%	%		22.Encl Frame Por						
					%	%		23.Attached Garag						
					%	%		24.Frame Shed						
					%	%		25.Frame Bay Wind						
					%	%		26.1SFr Overhang						
					%	%		27.Unfin Basement						
					%	%		28.Unfinished Att						
					%	%		29.Finished Attic						

CLIFFORD, REGINA  
279 WEST RD  
BOWDOIN ME 04287

B1876P320 B3323P80

Previous Owner  
CLIFFORD, PERCY D  
279 WEST RD

BOWDOIN ME 04287  
Sale Date: 9/16/2011

Inspection Witnessed By:

X	Date	
No./Date	Description	Date Insp.

Notes:

**Bowdoin**

Property Data			Assessment Record				
Neighborhood <b>9 Map 9</b>			Year	Land	Buildings	Exempt	Total
Tree Growth Year <b>0</b>			2009	58,600	56,760	10,000	105,360
Farmland Yr <b>0</b>			2010	58,600	56,760	10,000	105,360
Open Space Yr <b>0</b>			2011	58,600	56,760	10,000	105,360
Zone/Land Use <b>11 Residential 1</b>			2012	53,100	56,760	10,000	99,860
Secondary Zone			2013	53,100	52,750	10,000	95,850
Topography			2014	53,100	52,750	10,000	95,850
1.Level 4.Below St 7.LevelBog			2015	53,100	45,030	10,000	88,130
2.Rolling 5.Low 8.Conform			2016	53,100	45,030	15,000	83,130
3.Above St 6.FZone 9.Non-Confor			2017	53,100	45,030	20,000	78,130
Utilities			2018	66,100	45,030	20,000	91,130
1.Public 4.Dr Well 7.Cesspool			2019	66,100	58,380	20,000	104,480
2.Water 5.Dug Well 8.			2020	66,100	58,380	25,000	99,480
3.Sewer 6.Septic 9.None			2021	66,100	58,380	25,000	99,480
Street <b>1 Paved</b>			2022	66,100	50,160	21,500	94,760
1.Paved 4.Proposed 7.MHG			<b>Land Data</b>				
2.Semi Imp 5.R/O/W 8.DIS							
3.Gravel 6.MHP 9.None			<b>Front Foot</b>				
TG PLAN YEAR <b>0</b>							
Tif District # <b>0</b>			<b>Type</b>				
<b>Sale Data</b>							
Sale Date <b>9/16/2011</b>			<b>Effective</b>				
Price							
Sale Type <b>2 Land &amp; Buildings</b>			<b>Influence</b>				
1.Land 4.Mobile 7.C/I L&B							
2.L & B 5.Other 8.			<b>Influence Codes</b>				
3.Building 6.C/I Land 9.							
Financing <b>9 Unknown</b>			<b>Acres</b>				
1.Convent 4.Seller 7.							
2.FHA/VA 5.Private 8.			<b>Fract. Acre</b>				
3.Assumed 6.Cash 9.Unknown							
Validity <b>2 Related Parties</b>			<b>Acres/Sites</b>				
1.Valid 4.Split 7.Renovate							
2.Related 5.Partial 8.Other			<b>Total Acreage</b> 5.00				
3.Distress 6.Exempt 9.Short							
Verified <b>5 Public Record</b>			46.Golf Course				
1.Buyer 4.Agent 7.Family							
2.Seller 5.Pub Rec 8.Other							
3.Lender 6.MLS 9.							

Front Foot	Type	Effective		Influence		Influence Codes
		Frontage	Depth	Factor	Code	
11.Road Frontage				%		1.Unimproved
12.Delta Triangle				%		2.Excess Frtg
13.Nabla Triangle				%		3.Topography
14.Rear Land				%		4.Size/Shape
15.Miscellaneous				%		5.Access
				%		6.Restriction
				%		7.Open Space
				%		8.View/Environ
				%		9.Fract Share
				%		30.Rear Land 3
				%		31.Tillable
				%		32.Pasture
				%		33.Orchard
				%		34.Softwood F&O
				%		35.Mixed Wood F&O
				%		36.Hardwood F&O
				%		37.Softwood TG
				%		38.Mixed Wood TG
				%		39.Hardwood TG
				%		40.Wasteland
				%		41.Commercial
				%		42.2nd Site
				%		43.Post Rd
				%		44.Lot Improvemen
				%		45.Subdivision Lo

**Bowdoin**

Map Lot 09-18-0

Account 948

Location 279 WEST RD

Card 1 Of 1 7/19/2022

Building Style <b>0 Not Coded</b>	SF Bsmt Living <b>0</b>	Layout <b>0</b>
0.Not Code 4.Cape 8.Log	Fin Bsmt Grade <b>0 0</b>	1.Typical 4. 7.
1.Conv. 5.Garrison 9.Other	OCCUPANCY <b>0</b>	2.Inadeq 5. 8.
2.Ranch 6.Split 10.DW	Heat Type <b>100% 0 Not Coded</b>	3.Poor 6. 9.
3.R Ranch 7.Contemp 11.Church	0.Not Code 4.Steam 8.FI/Wall	Attic <b>0</b>
Dwelling Units <b>1</b>	1.HWBB 5.FWA 9.No Heat	1.1/4 Fin 4.Full Fin 7.
Other Units <b>0</b>	2.HWCI 6.GravWA 11.	2.1/2 Fin 5.FI/Stair 8.
Stories <b>0</b>	3.H Pump 7.Electric 12.	3.3/4 Fin 6. 9.None
1.1 4.1.5 7.4	Cool Type <b>0% 9 None</b>	Insulation <b>0</b>
2.2 5.1.75 8.20	1.Refrig 4.W&C Air 7.	1.Full 4.Minimal 7.
3.3 6.2.5 9.Yurt	2.Evapor 5. 8.	2.Heavy 5. 8.
Exterior Walls <b>0 Not Coded</b>	3.H Pump 6. 9.None	3.Capped 6. 9.None
0.Not Code 4.Asbestos 8.Concrete	Kitchen Style <b>0</b>	Unfinished % <b>0%</b>
1.Wood 5.Stucco 9.Other	1.Modern 4.Obsolete 7.	Grade & Factor <b>0 100%</b>
2.Vin/Al 6.Brick 10.Board B	2.Typical 5. 8.	1.E Grade 4.B Grade 7.
3.Compos. 7.Stone 12.	3.Old Type 6. 9.None	2.D Grade 5.A Grade 8.
Roof Surface <b>0</b>	Bath(s) Style <b>0</b>	3.C Grade 6.AA Grade 9.Same
1.Asphalt 4.Composit 7.	1.Modern 4.Obsolete 7.	SQFT (Footprint) <b>0</b>
2.Slate 5.Wood 8.	2.Typical 5. 8.	Condition <b>0</b>
3.Metal 6.Other 9.	3.Old Type 6. 9.None	1.Poor 4.Avg 7.V G
SF Masonry Trim <b>0</b>	# Rooms <b>0</b>	2.Fair 5.Avg+ 8.Exc
SEPTIC DESIGN <b>0</b>	# Bedrooms <b>0</b>	3.Avg- 6.Good 9.Same
BLDG PERMIT <b>1704</b>	# Full Baths <b>1</b>	Phys. % Good <b>0%</b>
Year Built <b>0</b>	# Half Baths <b>0</b>	Funct. % Good <b>100%</b>
Year Remodeled <b>0</b>	# Addn Fixtures <b>0</b>	Functional Code <b>9 None</b>
Foundation <b>0</b>	# Fireplaces <b>0</b>	1.Incomp 4.Delap 7.No Power
1.Concrete 4.Wood 7.	 <p><b>TRIO</b> Software A Division of Harris Computer Systems</p>	2.O-Built 5.Bsmt 8.LongTerm
2.C Block 5.Slab 8.		3.Damage 6.Dbwd 9.None
3.Br/Stone 6.Piers 9.		Econ. % Good <b>100%</b>
Basement <b>0</b>		Economic Code <b>None</b>
1.1/4 Bmt 4.Full Bmt 7.		0.None 3.No Power 7.
2.1/2 Bmt 5.None 8.		1.Location 4.Generate 8.
3.3/4 Bmt 6. 9.None		2.Encroach 6.None 9.
Bsmt Gar # Cars <b>0</b>		Entrance Code <b>5 Estimated</b>
Wet Basement <b>0</b>		1.Interior 4.Vacant 7.Entered
1.Dry 4. 7.		2.Refusal 5.Estimate 8.No
2.Damp 5. 8.	3.Informed 6.Reviewed 9.Land	
3.Wet 6. 9.	Information Code <b>1 Owner</b>	
	1.Owner 4.Agent 7.	
	2.Relative 5.Estimate 8.	
	3.Tenant 6.Other 9.	

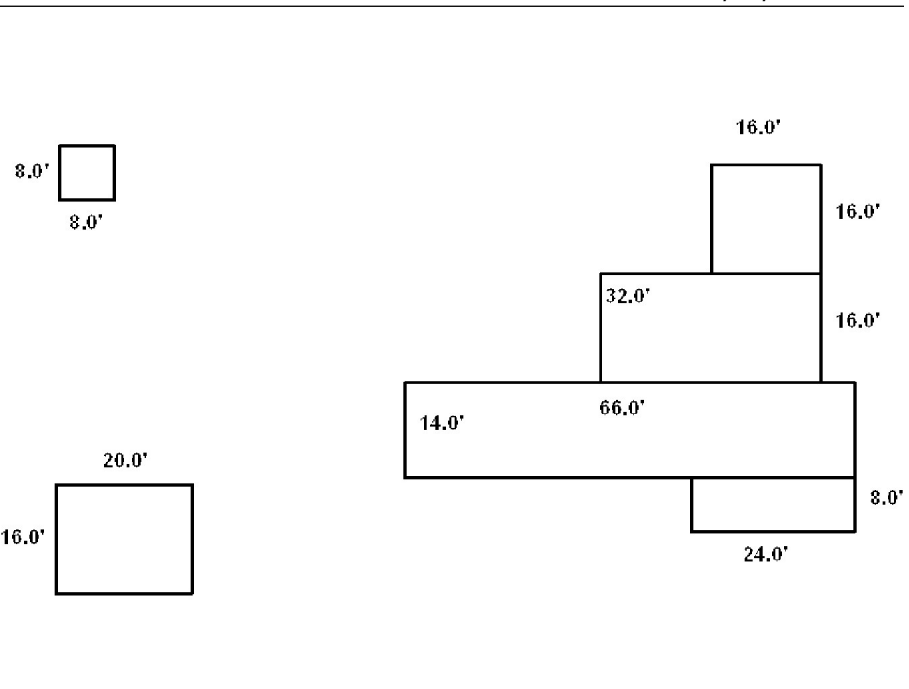

Date Inspected 4/06/2018

**Additions, Outbuildings & Improvements**

Type	Year	Units	Grade	Cond	Phys.	Funct.	Sound Value
998 14Mobile Home	1992	14x66	2 100	2	0 %	100 %	
1 One Story Frame	2003	512	2 100	2	0 %	90 %	
21 Open Frame	2006	192	2 100	2	0 %	75 %	
68 Wood Deck	2003	256	2 100	2	0 %	100 %	
30 Detached Garage	2007	320	2 100	2	0 %	75 %	
24 Frame Shed	2007				%	%	300
					%	%	
					%	%	
					%	%	
					%	%	
					%	%	



CLIFFORD, REGINA  
279 WEST RD  
BOWDOIN ME 04287

			Property Data			Assessment Record				
			Neighborhood	9 Map 9		Year	Land	Buildings	Exempt	Total
			Tree Growth Year	0		2018	0	9,090	0	9,090
			Farmland Yr	0		2019	0	9,090	0	9,090
			Open Space Yr	0		2020	0	9,090	0	9,090
			Zone/Land Use	11 Residential 1		2021	0	9,090	0	9,090
			Secondary Zone			2022	0	9,090	0	9,090
			Topography							
			1.Level	4.Below St	7.LevelBog					
			2.Rolling	5.Low	8.Conform					
			3.Above St	6.FZone	9.Non-Confor					
			Utilities							
			1.Public	4.Dr Well	7.Cesspool					
			2.Water	5.Dug Well	8.					
			3.Sewer	6.Septic	9.None					
			Street	1 Paved						
			1.Paved	4.Proposed	7.MHG					
			2.Semi Imp	5.R/O/W	8.DIS					
			3.Gravel	6.MHP	9.None					
			TG PLAN YEAR	0						
Inspection Witnessed By:			Tif District #	0						
			<b>Sale Data</b>							
X			Sale Date							
			Price							
No./Date	Description	Date Insp.	Sale Type							
			1.Land	4.Mobile	7.C/I L&B					
			2.L & B	5.Other	8.					
			3.Building	6.C/I Land	9.					
Notes:			Financing							
			1.Convent	4.Seller	7.					
			2.FHA/VA	5.Private	8.					
			3.Assumed	6.Cash	9.Unknown					
			Validity							
			1.Valid	4.Split	7.Renovate					
			2.Related	5.Partial	8.Other					
			3.Distress	6.Exempt	9.Short					
			Verified							
			1.Buyer	4.Agent	7.Family					
			2.Seller	5.Pub Rec	8.Other					
			3.Lender	6.MLS	9.					
						<b>Fract. Acre</b>				
						21.Base 1 (Fract)				
						22.Base 2 (Fract)				
						23.Base 3				
						<b>Acres</b>				
						24.Base 1				
						25.Base 2				
						26.Frontage 1				
						27.Rear Land 4				
						28.Rear Land 1				
						29.Rear Land 2				
								<b>Total Acreage</b>	0.00	

Bowdoin

Front Foot	Type	Effective		Influence		Influence Codes
		Frontage	Depth	Factor	Code	
11.Road Frontage				%		1.Unimproved
12.Delta Triangle				%		2.Excess Frtg
13.Nabla Triangle				%		3.Topography
14.Rear Land				%		4.Size/Shape
15.Miscellaneous				%		5.Access
				%		6.Restriction
				%		7.Open Space
				%		8.View/Environ
				%		9.Fract Share
				%		<b>Acres</b>
				%		30.Rear Land 3
				%		31.Tillable
				%		32.Pasture
				%		33.Orchard
				%		34.Softwood F&O
				%		35.Mixed Wood F&O
				%		36.Hardwood F&O
				%		37.Softwood TG
				%		38.Mixed Wood TG
				%		39.Hardwood TG
				%		40.Wasteland
				%		41.Commercial
				%		42.2nd Site
				%		43.Post Rd
				%		44.Lot Improvemen
				%		45.Subdivision Lo
				%		46.Golf Course



WINCHESTER, CHRISTINE H  
297 WEST RD  
BOWDOIN ME 04287

B394P387 B2015RP9369 B3279P202 B2016RP4813

Previous Owner  
ROWE, JUDITH E  
297 WEST RD

BOWDOIN ME 04287  
Sale Date: 8/23/2019

Previous Owner  
MOORE, DEVISEES OF ADAM J  
c/o DOUGLASS S. MOORE  
735 NEWELL BROOK RD  
DURHAM ME 04222  
Sale Date: 6/15/2016

Previous Owner  
VANZILE, EARL  
1146 COUNTY RD 135E LOT 4

NEW ALBANY MS 38652 9673  
Sale Date: 3/22/2011

Inspection Witnessed By:

X	Date
No./Date	Description
	Date Insp.

Notes:

**Bowdoin**

Property Data			Assessment Record						
Neighborhood <b>9 Map 9</b>			Year	Land	Buildings	Exempt	Total		
Tree Growth Year <b>0</b>			2009	76,460	227,570	0	304,030		
Farmland Yr <b>0</b>			2010	56,460	226,990	0	283,450		
Open Space Yr <b>0</b>			2011	56,460	226,990	0	283,450		
Zone/Land Use <b>11 Residential 1</b>			2012	56,460	226,990	0	283,450		
Secondary Zone			2013	56,460	226,990	0	283,450		
Topography			2014	56,460	182,160	0	238,620		
1.Level 4.Below St 7.LevelBog			2015	56,460	182,160	0	238,620		
2.Rolling 5.Low 8.Conform			2016	56,460	182,160	0	238,620		
3.Above St 6.FZone 9.Non-Confor			2017	56,460	182,160	20,000	218,620		
Utilities			2018	56,460	186,080	20,000	222,540		
1.Public 4.Dr Well 7.Cesspool			2019	56,460	186,080	20,000	222,540		
2.Water 5.Dug Well 8.			2020	56,460	192,560	0	249,020		
3.Sewer 6.Septic 9.None			2021	56,460	253,820	25,000	285,280		
Street <b>1 Paved</b>			2022	56,460	170,450	21,500	205,410		
1.Paved 4.Proposed 7.MHG			<b>Land Data</b>						
2.Semi Imp 5.R/O/W 8.DIS									
3.Gravel 6.MHP 9.None			<b>Front Foot</b>	<b>Type</b>	<b>Effective</b>		<b>Influence</b>		<b>Influence Codes</b>
TG PLAN YEAR <b>0</b>			11.Road Frontage		<b>Frontage</b>	<b>Depth</b>	<b>Factor</b>	<b>Code</b>	
Tif District # <b>0</b>			12.Delta Triangle				%		1.Unimproved
<b>Sale Data</b>			13.Nabla Triangle				%		2.Excess Frtg
Sale Date <b>10/30/2020</b>			14.Rear Land				%		3.Topography
Price			15.Miscellaneous				%		4.Size/Shape
Sale Type <b>2 Land &amp; Buildings</b>							%		5.Access
1.Land 4.Mobile 7.C/I L&B							%		6.Restriction
2.L & B 5.Other 8.			<b>Square Foot</b>	<b>Square Feet</b>					7.Open Space
3.Building 6.C/I Land 9.			16.Regular Lot				%		8.View/Environ
Financing <b>9 Unknown</b>			17.Secondary Lot				%		9.Fract Share
1.Convent 4.Seller 7.			18.Hydro Facility				%		<b>Acres</b>
2.FHA/VA 5.Private 8.			19.Improvements				%		30.Rear Land 3
3.Assumed 6.Cash 9.Unknown			20.Base 3 (Fract)				%		31.Tillable
Validity <b>1 Arms Length Sale</b>			<b>Fract. Acre</b>	<b>Acres/Sites</b>					32.Pasture
1.Valid 4.Split 7.Renovate			21.Base 1 (Fract)	24	1.00	100	%	0	33.Orchard
2.Related 5.Partial 8.Other			22.Base 2 (Fract)	28	6.40	100	%	0	34.Softwood F&O
3.Distress 6.Exempt 9.Short			23.Base 3	44	1.00	100	%	0	35.Mixed Wood F&O
Verified <b>5 Public Record</b>			<b>Acres</b>	52	450.00	100	%	0	36.Hardwood F&O
1.Buyer 4.Agent 7.Family			24.Base 1				%		37.Softwood TG
2.Seller 5.Pub Rec 8.Other			25.Base 2				%		38.Mixed Wood TG
3.Lender 6.MLS 9.			26.Frontage 1				%		39.Hardwood TG
			27.Rear Land 4				%		40.Wasteland
			28.Rear Land 1				%		41.Commercial
			29.Rear Land 2				%		42.2nd Site
			<b>Total Acreage</b>		<b>7.40</b>				43.Post Rd
									44.Lot Improvemen
									45.Subdivision Lo
									46.Golf Course



**Bowdoin**

Map Lot 09-19-0

Account 949

Location 297 WEST RD

Card 1 Of 1 7/19/2022

Building Style <b>1 Conventional</b>	SF Bsmt Living <b>0</b>	Layout <b>1 Typical</b>
0.Not Code 4.Cape 8.Log	Fin Bsmt Grade <b>0 0</b>	1.Typical 4. 7.
1.Conv. 5.Garrison 9.Other	OCCUPANCY <b>0</b>	2.Inadeq 5. 8.
2.Ranch 6.Split 10.DW	Heat Type <b>100% 1 Hot Water BB</b>	3.Poor 6. 9.
3.R Ranch 7.Contemp 11.Church	0.Not Code 4.Steam 8.F/Wall	Attic <b>9 None</b>
Dwelling Units <b>1</b>	1.HWBB 5.FWA 9.No Heat	1.1/4 Fin 4.Full Fin 7.
Other Units <b>0</b>	2.HWCI 6.GravWA 11.	2.1/2 Fin 5.F/Stair 8.
Stories <b>4 One &amp; 1/2 Story</b>	3.H Pump 7.Electric 12.	3.3/4 Fin 6. 9.None
1.1 4.1.5 7.4	Cool Type <b>0% 9 None</b>	Insulation <b>1 Full</b>
2.2 5.1.75 8.20	1.Refrig 4.W&C Air 7.	1.Full 4.Minimal 7.
3.3 6.2.5 9.Yurt	2.Evapor 5. 8.	2.Heavy 5. 8.
Exterior Walls <b>9 Other</b>	3.H Pump 6. 9.None	3.Capped 6. 9.None
0.Not Code 4.Asbestos 8.Concrete	Kitchen Style <b>2 Typical</b>	Unfinished % <b>0%</b>
1.Wood 5.Stucco 9.Other	1.Modern 4.Obsolete 7.	Grade & Factor <b>3 Average 100%</b>
2.Vin/Al 6.Brick 10.Board B	2.Typical 5. 8.	1.E Grade 4.B Grade 7.
3.Compos. 7.Stone 12.	3.Old Type 6. 9.None	2.D Grade 5.A Grade 8.
Roof Surface <b>1 Asphalt Shingles</b>	Bath(s) Style <b>2 Typical Bath(s)</b>	3.C Grade 6.AA Grade 9.Same
1.Asphalt 4.Composit 7.	1.Modern 4.Obsolete 7.	SQFT (Footprint) <b>1008</b>
2.Slate 5.Wood 8.	2.Typical 5. 8.	Condition <b>3 Below Average</b>
3.Metal 6.Other 9.	3.Old Type 6. 9.None	1.Poor 4.Avg 7.V G
SF Masonry Trim <b>0</b>	# Rooms <b>13</b>	2.Fair 5.Avg+ 8.Exc
SEPTIC DESIGN <b>0</b>	# Bedrooms <b>5</b>	3.Avg- 6.Good 9.Same
BLDG PERMIT <b>0</b>	# Full Baths <b>2</b>	Phys. % Good <b>0%</b>
Year Built <b>1979</b>	# Half Baths <b>1</b>	Funct. % Good <b>100%</b>
Year Remodeled <b>0</b>	# Addn Fixtures <b>0</b>	Functional Code <b>9 None</b>
Foundation <b>5 Concrete Slab</b>	# Fireplaces <b>1</b>	1.Incomp 4.Delap 7.No Power
1.Concrete 4.Wood 7.		2.O-Built 5.Bsmt 8.LongTerm
2.C Block 5.Slab 8.		3.Damage 6.Dbwld 9.None
3.Br/Stone 6.Piers 9.		Econ. % Good <b>100%</b>
Basement <b>0</b>		Economic Code <b>None</b>
1.1/4 Bmt 4.Full Bmt 7.		0.None 3.No Power 7.
2.1/2 Bmt 5.None 8.		1.Location 4.Generate 8.
3.3/4 Bmt 6. 9.None		2.Encroach 9.None 9.
Bsmt Gar # Cars <b>0</b>		Entrance Code <b>1 Interior Inspect</b>
Wet Basement <b>0</b>		1.Interior 4.Vacant 7.Entered
1.Dry 4. 7.		2.Refusal 5.Estimate 8.No
2.Damp 5. 8.		3.Informed 6.Reviewed 9.Land
3.Wet 6. 9.		Information Code <b>1 Owner</b>
		1.Owner 4.Agent 7.
		2.Relative 5.Estimate 8.
		3.Tenant 6.Other 9.



Date Inspected 4/09/2018

**Additions, Outbuildings & Improvements**

Type	Year	Units	Grade	Cond	Phys.	Funct.	Sound Value
1 One Story Frame	1979	760	3 90	3	0 %	90 %	
22 Encl Frame Porch	2000	320	3 90	3	0 %	100 %	
21 Open Frame	1979	288	3 100	3	0 %	85 %	
23 Attached Garage	2005	780	3 100	3	0 %	95 %	
24 Frame Shed	2013	480	2 100	3	0 %	90 %	
63 Swimming Pool	2000	0	2 90	2	0 %	90 %	
24 Frame Shed	2017	288	3 100	4	0 %	100 %	
63 Swimming Pool	2019	1	3 100	3	0 %	100 %	
					%	%	
					%	%	

